

2017 National RHY Grantees Training Kansas City, MO | November 14 – 16, 2017

Youth At The Crossroads: Selecting Promising Paths

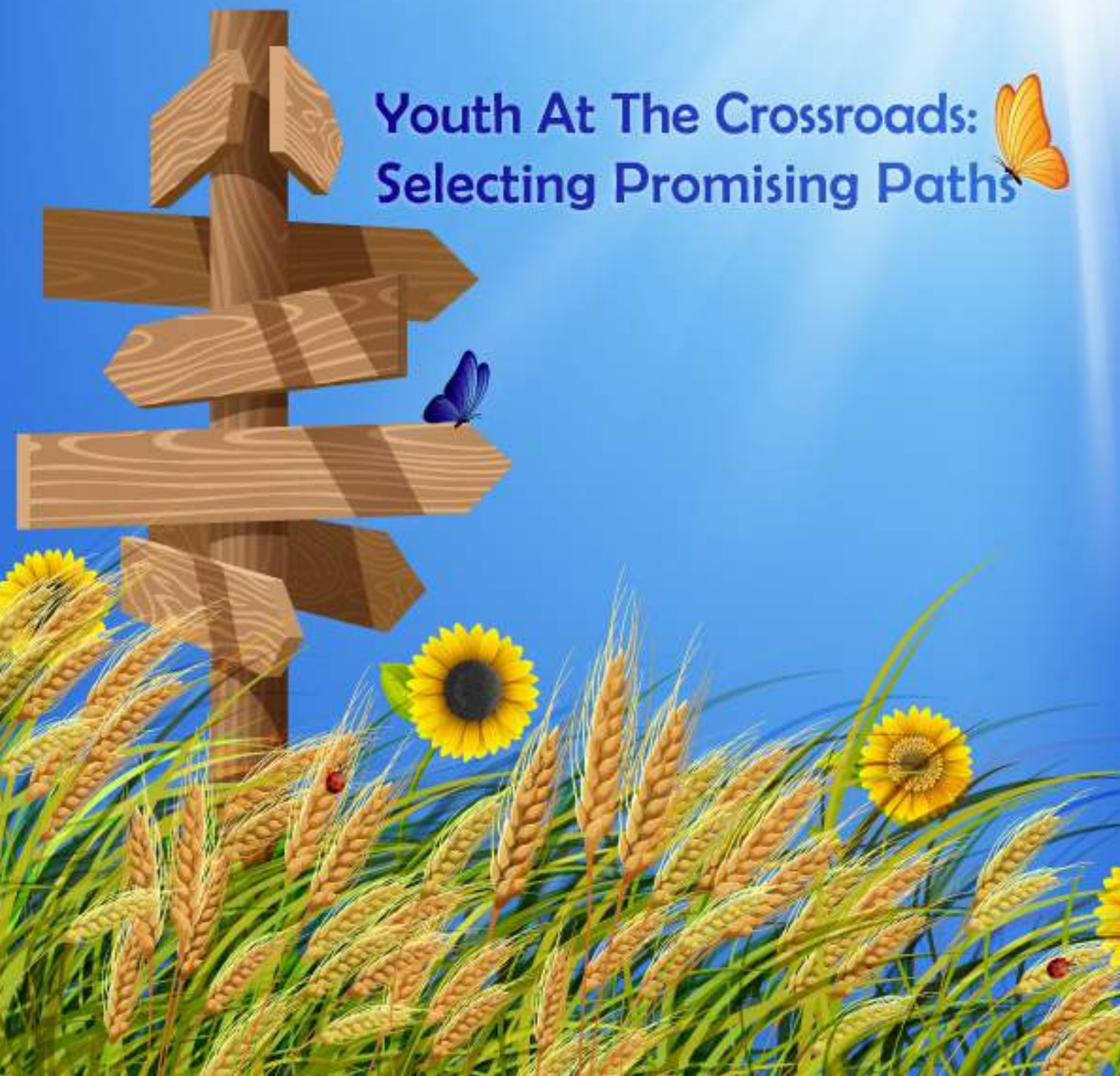



ADMINISTRATION FOR
CHILDREN & FAMILIES

330 C Street, S.W., Washington, DC 20201 www.acf.hhs.gov

November 14, 2017

Dear Runaway and Homeless Youth Partners:

On behalf of the Administration on Children, Youth and Families at the U.S. Department of Health and Human Services, it is our honor to welcome you to this year's Family and Youth Services Bureau (FYSB) Runaway and Homeless Youth (RHY) Training Conference.

We are excited that you are joining us for our 11th annual grantee training conference. Over the next few days we will get to know one another and learn from one another. We'll share our experiences, hear about the latest research, discover evidence-based approaches, and explore best practices. It is our hope that our work together can jump-start a collective strategic approach that embraces both collaboration and accountability in our efforts to address homelessness among our youth in America. The past year has also been one of new beginnings for FYSB and the RHY program. In addition to new leadership, we've recently signed engagements with three organizations to support the work that we all do in very significant ways, the Runaway and Homeless Youth Training & Technical Assistance Center (RHYTTAC), the National Runaway Safeline (NRS), and the newest member of our partnership, the National Clearinghouse for Homeless Youth and Families (NCHYF), which replaces the National Clearinghouse on Families and Youth. New agreements with these organizations will bring fresh approaches to our collaboration with the goal of making your work more efficient and effective.

The new clearinghouse, now more focused on RHY programs than its predecessor, will provide information and resources to grantees and others who are developing and implementing prevention and intervention services for runaway and homeless youth and their families. This new endeavor will bring renewed energy and attention to RHY grantees and their work. NCHYF will work closely with our partners supporting the Family Violence Prevention and Services and Adolescent Pregnancy Prevention Programs, giving RHY an equal seat at the table.

We are also excited to launch the new national communication system for homeless youth, in partnership with our trusted partners at the National Runaway Safeline. This marks a new phase in the federal government's effort to give immediate, personalized, and confidential help to every homeless or at-risk young person in the country. The new communication system brings NRS's trained, expert staff under the FYSB umbrella and enhances our ability to help all young people when they need it most.

A new agreement with RHYTTAC will secure the continued exchange of up-to-date promising practices and foster capacity building to support youth organizations across the country as they work to provide safety and permanency and to improve the social and emotional well-being of runaway, homeless, and street youth.

In the selection of these allies, as in the selection of all of our grantees, we look for partners who will give us the greatest return on investment, those that can help us support youth in the most effective ways, and those that will achieve the most productive exchange of resources and ideas and provide the services that will strengthen our individual and collective achievements.



ADMINISTRATION FOR
CHILDREN & FAMILIES

330 C Street, S.W., Washington, DC 20201 www.acf.hhs.gov

We are so grateful for the work you do and for taking the time out of your busy schedules to join us here in Kansas City. The FYSB RHY program is enriched by your expertise and commitment, and I look forward to strengthening our work together on behalf of the nation's runaway and homeless youth and their families. I look forward to meeting you all and wish you all the best!

In partnership,

William Wubbenhorst
Associate Commissioner
Family and Youth Services Bureau

**Sometimes the right path
is not the easiest one.**

— Grandmother Willow, Disney Pictures

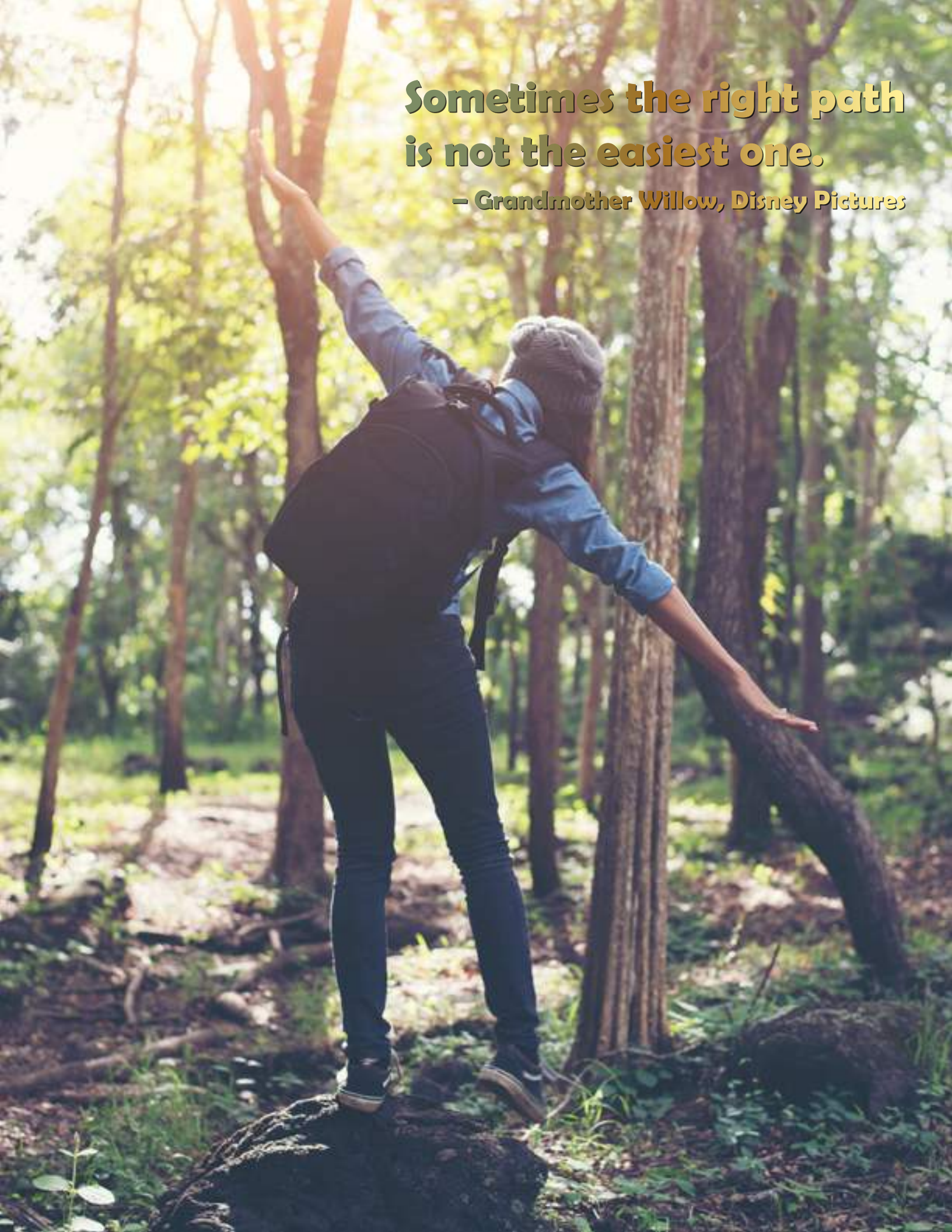

GENERAL INFORMATION

National RHY Grantees Training App

NEW! This year's training features an event application (app). Attendees can use the app to view training session descriptions and create a personalized schedule, learn about speakers and exhibitors, provide feedback, quickly access floor plans, connect with RHYTTAC through the social media widget, create an attendee profile, see who's at the event, network, and receive personalized messages—including door prize winner notifications, invites to exclusive events, and up-to-date event notifications. The app may be downloaded to a device. It is also accessible through a browser on a phone, tablet, laptop, or desktop. Download or view the app now at www.rhyttac.net/training-app.





Evaluations

NSPN encourages attendees to consider sharing session feedback and overall training evaluation in the 2017 National RHY Grantees Training app! As personalized schedules are created in the app, a “Session Feedback” section is made available beneath the details and description of each session. Feedback may be shared after each session. At the end of the 2017 National RHY Grantees Training, attendees may tap “Share your experience” on the app home page to provide an overall evaluation.

If access to a smartphone is not available, paper evaluation forms may be obtained from session moderators. General session feedback forms are available at the Training Information Center. Regardless of how feedback is provided, NSPN needs to hear from grantees to continue efforts to improve RHYTTAC training events. Session feedback and overall evaluations are greatly appreciated!

Door Prizes

Door prize winners will be drawn periodically and announced via the training app and posted at the Training Information Center. If a notification is received, stop by the Training Information Center to claim a prize.

Stipend Information

Stipends are made available to FYSB-funded RHY grantees who attend the National RHY Grantees Training. These stipends are not intended to fully cover the cost of participation for the training. Each grantee is required to include costs in their RHY program budget for at least one attendee. However, recognizing the expense burden on grantees, stipends are provided as a supplement to grantees to support participation.

In order to receive stipend reimbursement:

1. Agencies must be a current RHY grantee.
2. Attendees must attend the training in its entirety (November 14–16, 2017).
3. Attendees or agencies must complete and submit the reimbursement form by the deadline of December 15, 2017.

To submit a stipend request, grantees should:

Complete the online stipend request form at www.rhyttac.net/stipend-request-17. All copies of receipts must be uploaded prior to submitting the form. Approved stipend requests are NOT processed after December 15. It is the responsibility of the grantee to follow up on all stipend requests. Under no circumstances will checks be issued to individuals. Reimbursements will only go to current grantee agencies.

Stipend Form Requirements

1. One stipend form is permitted per agency. (Note: The maximum stipend amount per agency is \$600.)
2. The form must include the following: attendee(s) name(s), RHY grantee agency name and contact information, signature of authorized organizational leader (Executive Director, Chief Executive Officer, Chief Operating Officer, Chief Financial Officer, etc.), and applicable receipts for allowed costs (airfare, mileage at .535 per mile, taxi or shuttle fares, parking or baggage fees, and hotel costs, excluding incidentals).
3. Travel and lodging receipts must have a zero balance and include payment information. Confirmation emails will not be accepted.



FEDERAL REPRESENTATIVES



William Wubbenhorst

Associate Commissioner
Administration on Children, Youth and Families
Family and Youth Services Bureau

William Wubbenhorst has worked in state government and consulted with state and federal governments for almost 30 years. During this time, he has also served as a consultant to, and researcher of, faith-based and community organizations. Mr. Wubbenhorst currently serves as a Non-Resident Fellow for the Institute for Studies of Religion (ISR) at Baylor University and Senior Fellow with the Sagamore Institute. Mr. Wubbenhorst is also a

Principal for Harvest Home Institute, LLC, and Co-founder of Social Capital Valuations, LLC.

Previously, Mr. Wubbenhorst served a total of 13 years as a Senior Management Consultant and Return On Investment (ROI) Specialist for ICF International and Macro International. He specialized in developing ROI measures for federal government programs that assist low-income and at-risk populations. During this time, he provided technical assistance to federal grantees funded through the U.S. Department of Labor, Department of Health and Human Services, and the Corporation for National and Community Service, and he served as Project Director for Training and Technical Assistance to the 98 National Responsible Fatherhood Grantees funded through the U.S. Department of Health and Human Services' Administration for Children and Families (HHS/ACF).

In addition to Mr. Wubbenhorst's technical assistance skills, he also has extensive knowledge of health care delivery systems. While at ICF International, Mr. Wubbenhorst served as Senior Performance Management Specialist for a project with the Agency for Healthcare Research and Quality (AHRQ) to help the agency identify cost-benefit impacts for the research projects and tools it developed for a variety of health care stakeholders, including state governments and health care providers. Prior to this work with ICF International, Mr. Wubbenhorst also served as Project Director for a three-year national study of clinical service lines for the Veterans Health Administration's 22 regional health networks and 140 medical centers. These consulting engagements with various health and social programs were designed to help these organizations identify, understand, and communicate their innovative practices to the public and peer organizations.

Over the years, Mr. Wubbenhorst has collaborated with professors from several prestigious academic institutions, including Baylor University, Boston University, and Harvard University, and he has published a variety of peer-reviewed journal publications and case studies. Most recently, Mr. Wubbenhorst co-authored a national study entitled "Assessing the Faith-Based Response to Homelessness in America: Findings from Eleven Cities," published through Baylor University's ISR. He also co-authored "Demonstrating the Value of Social Service Programs: A Simplified Approach to Calculating Return on Investment," a peer-reviewed article, published in *The Foundation Review* (September 2010). Mr. Wubbenhorst also co-authored an article entitled "Assessing the Effectiveness of the Violence Free Zone in Milwaukee Public Schools," published in *Journal of Knowledge and Best Practices in Juvenile Justice & Psychology* (2013). In total, Mr. Wubbenhorst has co-authored over 20 journal articles and evaluation case studies on subjects ranging from prisoner re-entry, faith and health initiatives, sexual risk avoidance programs, high-risk youth mentoring, and marriage and family strengthening.

Mr. Wubbenhorst attended Trinity College in Hartford, Connecticut, and received a BA in Intercultural Studies. He received an MBA with a concentration in Public and Non-Profit Management (Beta Gamma Sigma honors society) from Boston University, Massachusetts. Mr. Wubbenhorst has been married for over 31 years to Alfreda Alvarez, and they have two adult children.

**Debbie A. Powell**

Deputy Associate Commissioner
Administration on Children, Youth and Families
Family and Youth Services Bureau

Debbie A. Powell is the Deputy Associate Commissioner for the Family and Youth Services Bureau (FYSB), where she is the principal adviser to the FYSB Associate Commissioner on family and youth issues. Before coming to FYSB, Ms. Powell held various senior leadership positions at the Centers for Medicare and Medicaid Services, the Indian Health Service, and the Food and Drug Administration, where she held senior acquisition management and policy positions for more than 20 years. Most recently at the Administration for Children and Families (ACF), Ms.

Powell has held senior positions as the Director of Technical Assistance at the Child Care Bureau, the Director of Discretionary Grant Programs at the Office of Community Services, Deputy Commissioner at the Administration on Developmental Disabilities, and Branch Chief in the Division of Acquisition Management. Ms. Powell has provided sustained leadership for national and community-based programs that serve and support individuals with developmental disabilities and low-income individuals and families.

**Resa Matthew, PhD, MPH**

Director, Division of Adolescent Development and Support
Administration on Children, Youth and Families
Family and Youth Services Bureau

Dr. Resa Matthew has over 20 years of experience working with federal, state, and local governments on public health and behavioral health-related initiatives, including large, complex research and evaluation projects. Her work has focused on adolescent pregnancy prevention, homelessness among youth, HIV/AIDS to include rapid HIV testing, substance abuse, maternal and child health, mental health, and knowledge dissemination. She has published in peer-reviewed journals, presented at numerous conferences, and received several awards, including the Distinguished

Service Award for Evaluation.

Dr. Matthew currently serves as the Family and Youth Services Bureau's Director for the Division of Adolescent Development and Support in the Administration for Children and Families. She provides oversight for the Adolescent Pregnancy Prevention and Runaway and Homeless Youth programs that prevent pregnancy and the spread of sexually transmitted infections and promote safety, stability, and well-being for young people who have experienced or been exposed to violence, neglect, or trauma. Dr. Matthew has a PhD in Family Studies from the University of Maryland and an MPH in Health Promotion/ Disease Prevention from The George Washington University.



Christopher Holloway

Program Manager
Runaway and Homeless Youth Program
Family and Youth Services Bureau

Christopher Holloway is a Program Manager in the Administration for Children and Families' Family and Youth Services Bureau (FYSB), where he is responsible for managing training and technical assistance, research, evaluation, and program support for the Runaway and Homeless Youth (RHY) Program. Prior to joining FYSB and the RHY Program, Holloway served for more than 15 years in the Department of Justice (DOJ), where he led efforts in the Office for Victims of Crime (OVC) to provide support to victims of federal crime, terrorism, and incidents of mass casualty, and to those living in American Indian/Alaska Native communities.

During his tenure at the DOJ, Holloway served 12 years with the Office of Juvenile Justice and Delinquency Prevention (OJJDP), developing and managing initiatives to prevent and respond to missing and exploited children, to include the Internet Crimes Against Children Task Force Program and programs designed to address the commercial sexual exploitation and trafficking of children.

Keith Wallace

Regional Program Manager
Runaway and Homeless Youth Program
Family and Youth Services Bureau

Keith Wallace serves as the Regional Program Manager for Regions 1, 2, 3, and 6. He began his federal service in 2016. Wallace served as the Executive Director of a Runaway and Homeless Youth program that provided services to children and youth. He has over 20 years of experience as a grant writer and reviewer, peer reviewer, and training and technical assistance provider. Wallace was a 16-year-old runaway that never returned home, providing a unique perspective to his position. He received his Bachelor's Degree in Psychology from Hardin-Simmons University (HSU) and continued graduate studies in Family Therapy at HSU.

Areon Kelvington

Regional Program Manager
Runaway and Homeless Youth Program
Family and Youth Services Bureau

Areon Kelvington is a Regional Program Manager for Regions 4, 5, and 7. He has experience with RHY programs as a Program Director of a Basic Center and Street Outreach Program. Kelvington comes to Family and Youth Services Bureau (FYSB) from the Department of Labor, where he served as Director of the Veterans' Employment and Training Service (VETS). He led the agency's efforts in preparing America's veterans, service members, and their spouses for meaningful careers, providing them with employment resources and expertise, and protecting their employment rights and promoting their employment opportunities. During his tenure with VETS, Kelvington held senior positions in the National Office as the Executive Officer of Administration and Budget, and more recently, as the Director of the Office of Strategic Outreach and Legislative Affairs. He has a Master's Degree in Counseling and advanced professional graduate certificates in Coaching, Organizational Leadership, and Entrepreneurship.

Jeff Daniels

Regional Program Manager
Runaway and Homeless Youth Program
Family and Youth Services Bureau

Jeff Daniels is currently in the Dallas Regional Office, and in the near future he will be moving to the Denver Regional Office. Daniels has over 22 years of leadership, management, and administrative experience in government and with the Department of Defense, with expertise in leadership development, strategic planning, RHY program partnership, policy development, grant management, budget oversight, and Congressional finance. He has held leadership positions as the Family Service Center Director, Community Service Center Director, Youth Program Director, and Commanding Officer of a Transition Team. In his previous position while serving on active duty in the Marine Corps, Daniels was responsible for all fiscal, administrative, and management duties for an agency with a budget in excess of \$14 million annually. He led and supervised over 50 military and civilian personnel in a seven-state region, encompassing the Southwestern United States. Additionally, while serving as the Transition Team Commanding Officer, Daniels worked with the Iraqi Government, establishing runaway and homeless shelters, emergency clinics, and training procedures for over 100 personnel. He has a Bachelor of Science Degree in Government, a Master of Science Degree in Human Development from Texas A&M University, and an MBA from Webster University.

Daniels brings a wealth of skills and knowledge to the RHY program and FYSB is ready to utilize them to ensure continued success in the work RHY programs do to serve our nation's most vulnerable youth.



FYSB RHY STAFF

Title	Name	Email	Attending?
-------	------	-------	------------

Division of Adolescent Development and Support

Director	Resa Matthew	resa.matthew@acf.hhs.gov	Yes
----------	--------------	--------------------------	-----

Runaway and Homeless Youth Program Central Office

Program Manager	Christopher Holloway	christopher.holloway@acf.hhs.gov	Yes
Program Specialist	Toyin Akintoye	oluwatoyin.akintoye@acf.hhs.gov	
Program Specialist	Karal Busch	karal.busch@acf.hhs.gov	
Program Specialist	Ana Cody	ana.cody@acf.hhs.gov	
Program Specialist	Gloria Watkins	gloria.watkins@acf.hhs.gov	Yes
Program Specialist	Angie Webley	angie.webley@acf.hhs.gov	Yes

Runaway and Homeless Youth Program Regional Office – 1, 2, 3, & 6

Program Manager	Keith Wallace	keith.wallace@acf.hhs.gov	Yes
Program Specialist R2	Danny Balkcom	danny.balkcom@acf.hhs.gov	Yes
Program Specialist R2	Esceta McGee	esceta.mcgee@acf.hhs.gov	
Program Specialist R2	Myrna Quintana	myrna.quintana@acf.hhs.gov	
Program Specialist R3	Habibah Sulayman Smith	habibah.sulayman@acf.hhs.gov	Yes
Program Specialist R6	Rebecca Eichelberger	rebecca.eichelberger@acf.hhs.gov	Yes
Program Specialist R6	Paul Bowser	paul.bowser@acf.hhs.gov	

Runaway and Homeless Youth Program Regional Office – 4, 5, & 7

Program Manager	Areon Kelvington	areon.kelvington@acf.hhs.gov	Yes
Program Specialist R4	Carolyn Bates	carolyn.bates@acf.hhs.gov	Yes
Program Specialist R4	Pamela Marr	pamela.marr@acf.hhs.gov	
Program Specialist R4	Alicia Parks	alicia.parks@acf.hhs.gov	
Program Specialist R5	Bill Clair	bill.clair@acf.hhs.gov	
Program Specialist R5	Niki Lee	niki.lee@acf.hhs.gov	
Program Specialist R5	Jenny Weiser	jenny.weiser@acf.hhs.gov	
Program Specialist R5	Jessica Drazenovich	jessica.drazenovich@acf.hhs.gov	Yes
Program Specialist R7	Dr. Linda Cloud	linda.cloud@acf.hhs.gov	Yes
Program Specialist R7	Raymond Hicks	raymond.hicks@acf.hhs.gov	Yes

Runaway and Homeless Youth Program Regional Office – 8, 9, & 10

Program Manager	Jeffrey Daniels	jeffrey.daniels@acf.hhs.gov	Yes
Program Specialist R8	Deb Yatsko	deborah.yatsko@acf.hhs.gov	Yes
Program Specialist R9	Deborah Oppenheim	deborah.oppenheim@acf.hhs.gov	
Program Specialist R9	Petrina Winston	petrina.winston@acf.hhs.gov	Yes
Program Specialist R10	Thomas Bonnington	thomas.bonnington@acf.hhs.gov	
Program Specialist R10	Janice Holt	janice.holt@acf.hhs.gov	Yes
Program Specialist R10	Steve Ice	steve.ice@acf.hhs.gov	

National Runaway Prevention Month

November is National Runaway Prevention Month (NRPM). Wednesday, November 15, is a day set aside for candlelight vigils for all runaway youth. National Runaway Safeline and National Safe Place Network have partnered to support your participation in this awareness activity by providing a small, battery-operated flameless candle in your training tote. On Wednesday, you're encouraged to "light" your candle and place it in your hotel room where it will be visible from the outside.

Be sure to "help your friends" by reminding them to "light the night" in honor of all runaways and to help generate awareness about prevention efforts across the nation. Thank you for all you do to assist runaway and homeless youth. Your efforts to light the way for so many youth really do make a difference! #NRPM2017



Light the Night | #NRPM2017

Between 1.6 and 2.8 million youth run away in a year. If all of these young people lived in one city, it would be the fifth largest city in the United States. These numbers are unacceptable, particularly when you consider the fact that many of these young people will end up on the streets. These are not bad kids; they are good kids in bad situations. By supporting NRPM, you are showing America's runaway and homeless youth that they are not invisible and they are not alone. #NRPM2017 #EndYouthHomelessness

FEATURED KEYNOTES



Sharon W. Cooper, MD, FAAP

Developmental and Forensic Pediatrician

Department of Pediatrics in the School of Medicine at the University of North Carolina at Chapel Hill

Sharon Cooper is a developmental and forensic pediatrician who evaluates and treats children who have been victims of all forms of abuse, though her primary area of expertise is that of sexual exploitation. Dr. Cooper holds faculty positions in the Department of Pediatrics in the School of Medicine at the University of North Carolina at Chapel Hill and at Uniformed Services University of the Health Sciences in Bethesda, Maryland. She is a consultant and board member of the National Center for Missing & Exploited Children. She has lectured nationally and

internationally and has provided Congressional testimony in the United States; Russia; Manitoba, Canada; and Italy on child sexual exploitation. Dr. Cooper recently served as a task force member on “Defending Childhood,” a report of the Attorney General’s National Task Force on Children Exposed to Violence, having been appointed by Attorney General Eric Holder.



Andrew Gluck, MBA

Carnegie Mellon University

Andrew Gluck has been serving public and non-profit sector funders and their grantees as a management consultant, designing and implementing performance measurement/management systems for more than 25 years. Since 1993, he has assisted his federal sector clients in satisfying the requirements of the Government Performance and Results Act of 1993 (GPRA) and the GPRA Modernization Act of 2010 (GPRAMA). Gluck continues to introduce analytic models and performance measurement systems for his public-sector clients to support and encourage data-driven decision making and the use of evidence-based practices to improve results-oriented performance. He works with leadership at federal, state, and local

agencies to construct logic models that serve as the underpinning of strategic plans, operating plans, and performance measures that align departmental, organizational, and personal goals and objectives. Gluck was the principal author of an innovative approach for monetizing outcomes using expected value to calculate taxpayers’ return on investment.

**Merita Irby**

Managing Partner, Big Picture Approach Consulting

Co-Founder and Executive Vice President, The Forum for Youth Investment

Merita Irby is a chief architect of both The Forum for Youth Investment (the Forum) and its signature initiative, Ready by 21®. Having founded the Forum with Karen Pittman in 1998, she is now its leader of strategic planning and serves as a lead facilitator of Ready by 21 activities, from workshops and symposiums to ongoing learning groups. As a coach for Ready by 21 changemakers, Irby works with key leaders from school districts, governmental departments, community collaboratives, and non-governmental organizations nationwide.

Currently, Irby co-leads the coaching team for The Wallace Foundation's Partnerships for Social and Emotional Learning Initiative with CASEL and the Weikart Center for Youth Program Quality. She is also working on a research brief for the Creative Youth Development National Partnership to assist in developing a blueprint for cross-sector advancement of creative youth development.



11:00 a.m. – 8:00 p.m.
12:30 p.m. – 4:15 p.m.
1:00 p.m. – 5:00 p.m.

7:00 a.m. – 5:30 p.m.
8:30 a.m. – 10:30 a.m.
10:45 a.m. – 12:15 p.m.
12:15 p.m. – 1:45 p.m.
1:45 p.m. – 3:15 p.m.
3:30 p.m. – 5:00 p.m.
6:00 p.m. – 8:30 p.m.

7:30 a.m. – 5:30 p.m.
8:30 a.m. – 9:00 a.m.
9:00 a.m. – 10:30 a.m.
10:45 a.m. – 12:15 p.m.
12:15 p.m. – 2:30 p.m.

2:45 p.m. – 4:15 p.m.
2:45 p.m. – 5:30 p.m.
2:45 p.m. – 5:30 p.m.
4:15 p.m. – 4:45 p.m.

7:30 a.m. – 12:00 p.m.
8:30 a.m. – 11:00 a.m.

Monday, November 13

Training Registration
Site Visits:
Synergy Services, Inc., and reStart, Inc.
Topical Institutes

Tuesday, November 14

Training Registration
Exhibits Open
General Session: Opening
Workshop Session I
Lunch Break (on your own)
General Federal Session
Workshop Session II
Federal Regional Meetings
Grantees' Reception

Wednesday, November 15

Training Information Center Open
Exhibits Open
Poster Session Display Open
Poster Session Meet and Greet
Workshop Session III
Workshop Session IV
General Session:
National Clearinghouse
Mural Contest Winner Presentation
Keynote
Workshop Session V
Rural Focused Presentation (Parts I and II)
Site Visits:
Synergy Services, Inc., and reStart, Inc.
Poster Session Meet and Greet

Thursday, November 16

Training Information Center Open
Annual Banner Signing
General Session: Closing

FLOOR PLAN

BALLROOM LEVEL

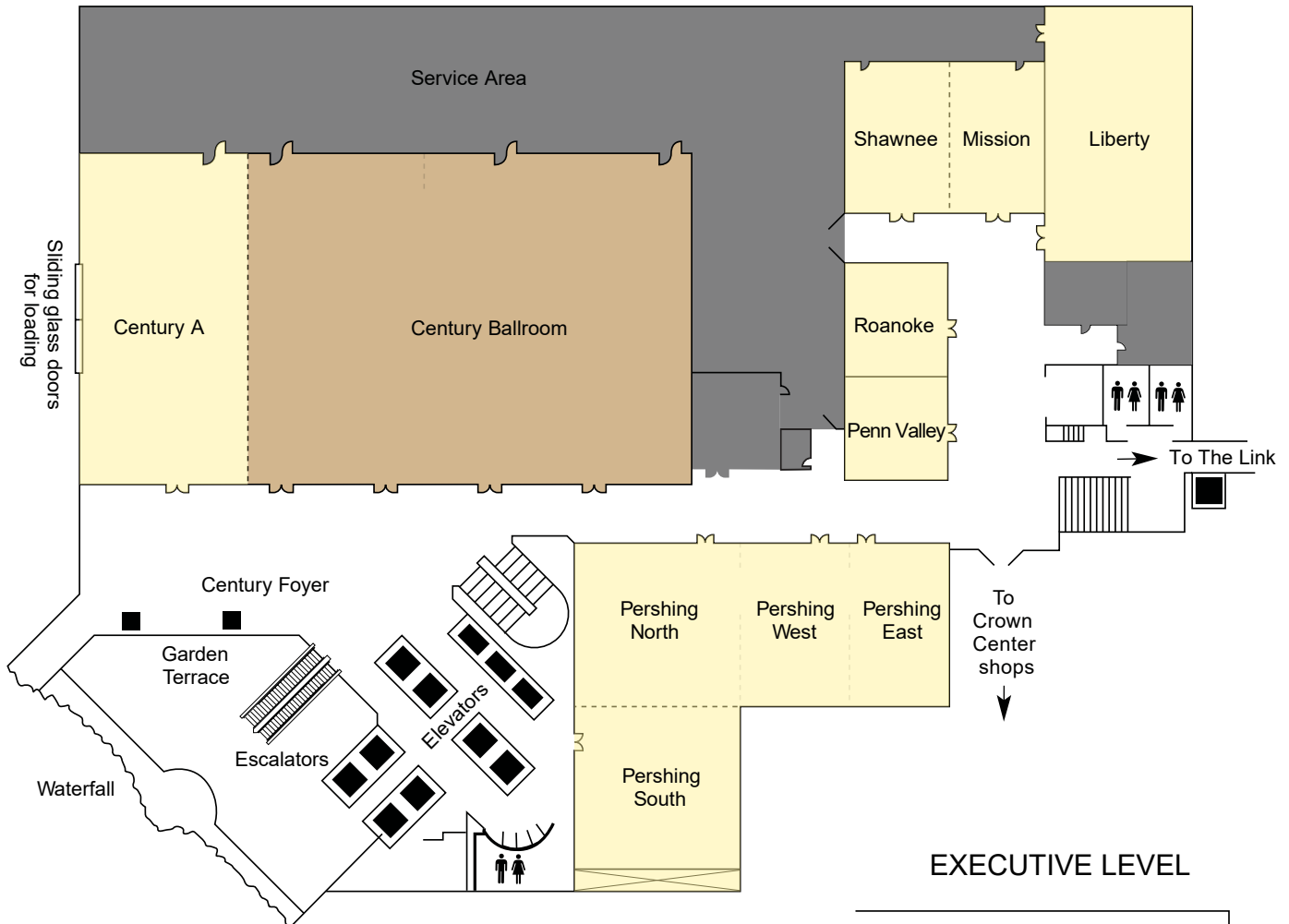

EXECUTIVE LEVEL

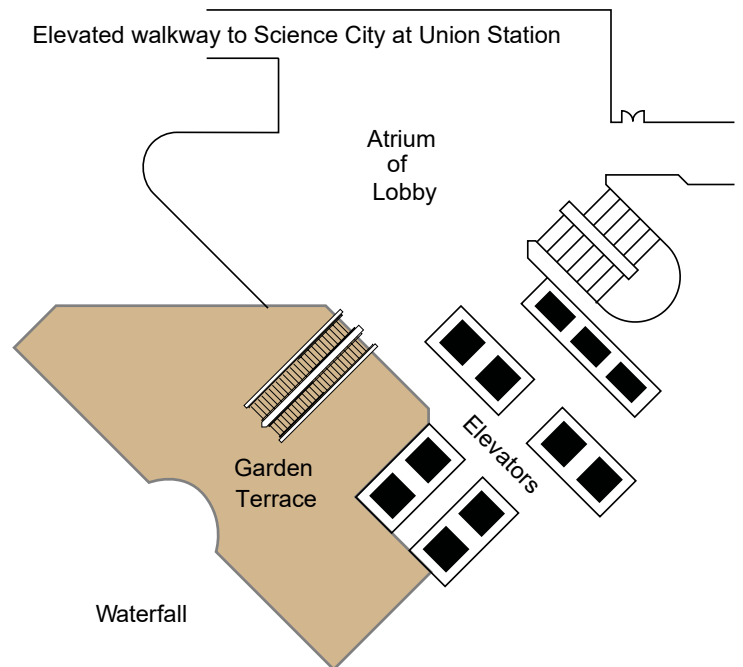

MONDAY, NOVEMBER 13

11:00 a.m. – 8:00 p.m.
Garden Terrace (Waterfall)

National Training Registration

12:30 p.m. – 4:15 p.m.

**Optional Site Visits:
Synergy Services, Inc., and reStart, Inc.**

Attendees with site visit tickets should meet at the front drive of the hotel by 12:30 p.m. Central time **with the site visit ticket** provided at check-in. Boarding will start at 12:30 p.m. and all participants must be in the boarding area by this time or risk losing their seat without a refund. Those interested in waiting in line for an opportunity to fill an empty seat may do so – please bring \$5 (exact change). RHYTTAC staff will begin filling empty seats at 12:40 p.m. until the allotted seat count is full.



Synergy's mission is to eliminate family violence, abuse, and neglect by providing quality services to persons of all ages. As a lifeline to families and individuals in crisis, Synergy strives to empower individuals, strengthen families, and develop the community through crisis intervention, shelter, counseling, advocacy, and education.

Synergy's Homeless Youth Campus has a full continuum of services available to homeless, runaway, and street youth, including 24-hour crisis line support, shelter, case management, counseling and therapeutic services, transitional living, permanent supportive housing, drop-in center, education and job preparation, advocacy and education services, arts, fitness and recreation, and prevention services. Synergy House, Synergy's teen emergency shelter, has been in existence since 1971 and has been a federally funded Basic Center Program since 1973.

reStart began as an overnight emergency shelter in 1981 in downtown Kansas City, Missouri. Incorporated in 1984 as a non-profit organization, reStart has evolved and expanded over 35 years of service to become a community leader advocating and modeling best practices for ending homelessness. reStart is dedicated to advocating for the homeless families, youth, and adults it serves and addressing the underlying causes of chronic and generational homelessness. reStart provides a full continuum of care, from emergency shelter to transitional and permanent housing for all members of the community regardless of race, ethnicity, gender, mental or physical disability, religion, sexual preference, age, sobriety, and health status, so that no homeless person is excluded from working toward stability and permanent housing.

1:00 p.m. – 5:00 p.m.

Topical Institutes

Century A

Working with Your Continuum of Care: Building Collaborations and a Seamless System of Care

Summary:

This institute will focus on the value of collaboration and strategies for successful partnering between RHY programs and community continuum of care organizations in developing and sustaining a seamless system of care. The institute will feature a panel of experts representing the RHY and HUD fields. The presentation will identify the shared goals and objectives of the HUD and RHY fields as well as the unique differences. Challenges and strategies of both will be identified for addressing the critical issues of RHY-HMIS, Point in Time Count and Youth Count, definitions of homelessness, the needs of special populations, system performance standards, and coordinated entry.

Objectives:

1. Participants will gain a better understanding of the shared goals and challenges of the HUD and RHY fields as well as differences.
2. Participants will gain a better appreciation for the value of collaboration and the importance of providing a voice for youth.
3. Participants will be provided with updates on HUD initiatives directed at youth and young adults (YYA) experiencing or at risk of homelessness, including the Youth Homeless Demonstration Program (YHDP) and 100-day challenges in 10 communities.
4. Participants will have the opportunity to discuss issues, share challenges of building effective collaborations, and learn successful strategies from colleagues and experts.

Presenters:

Caroline P. Crouse, U.S. Department of Housing and Urban Development (HUD)

John McGah, American Institutes for Research (AIR)

Karen Locke, Crosswinds Youth Services

Erin Strohbehn, Youth in Need

Catherine Hummel, Dream Tree Project



Liberty

Leadership Development: Growing Leaders in RHY Work

Summary:

Whether interested in moving into a supervisory role or already transitioning into agency leadership, navigating a change in roles is challenging. Being a good direct care worker doesn't ensure that an individual will be a good supervisor. Leadership is a skill that can be learned. This interactive skill-building session will address leadership philosophy and three core skills that help prepare supervisors to lead effectively.

Objectives:

1. Participants will develop a practice philosophy/perspective that provides a framework for effective leadership and identify how to help staff develop their own practice philosophy/perspective.
2. Participants will understand the need for planned supervision sessions and learn the key components of a successful supervisory session.
3. Participants will gain the key skills needed to plan, structure, and facilitate effective meetings.
4. Participants will learn the art and importance of providing feedback to staff "in the moment" (capitalizing on teachable moments).

Presenters:

Clayton Gonzales, Assistant Director of Programs, Urban Peak

Risa Rehmert, Director of Program Development, Wichita State University, Center For Combating Human Trafficking

Lisa Davis, President/CEO, Family Resources, Inc.

Kim McNear, Executive Director, Anchor House



TUESDAY, NOVEMBER 14

7:00 a.m. – 5:30 p.m.
Century Foyer

National Training Registration
Exhibits Open

8:30 a.m. – 10:30 a.m.

General Session

Century B/C

Welcome and Opening Remarks

Debbie Powell, Deputy Associate Commissioner, FYSB
William Wubbenhorst, Associate Commissioner, FYSB

Opening Keynote

Dr. Sharon Cooper, Developmental and Forensic Pediatrician, University of North Carolina at Chapel Hill

10:45 a.m. – 12:15 p.m.

Workshop Session I

Century A

Beyond Definitions: Using Stages of Change and Motivational Interviewing with RHY

Summary:

Meaningful engagement with youth is key for successful outcomes. This is why organizations must strive to implement effective practices in their programming. Stages of Change and Motivational Interviewing work in tandem to assess a person's readiness for change and evoke internal motivation. Motivational Interviewing is an evidence-based practice that can be utilized in all RHY programs. This session provides information that is designed to help participants leave with knowledge and skills that can be implemented in RHY programming at the completion of this workshop.

Objectives:

1. Participants will receive an overview of Stages of Change and Motivational Interviewing designed to prepare RHY workers to immediately use the practices in daily interactions with youth.
2. Participants will learn how to use the Center for Combating Human Trafficking's (CCHT) "Stages of Change and Motivational Interviewing Guide" to engage youth at any point in the change process.
3. Participants will use a CCHT Stages of Change/Motivational Interviewing worksheet designed to aid RHY workers in developing an individualized engagement strategy.
4. Participants will have the opportunity to put their engagement strategy to the test with fellow participants.

Presenters:

Dr. Karen Countryman-Roswurm, Executive Director, Wichita State University, Center for Combating Human Trafficking

Risa Rehmert, Director of Program Development, Wichita State University, Center For Combating Human Trafficking

Recommended Audiences:

All RHY/youth-serving professionals

Micro level—the most common practice; happens directly with an individual client or family

Experienced in the RHY field/workshop topic



Pershing South Federal Policy Impacting Runaway and Homeless Youth Services

Summary:

The new Congress and Presidential Administration are working to tackle a range of issues that directly impact the lives of children, families, and youth experiencing homelessness: federal funding; reauthorization of the Runaway and Homeless Youth Act, Juvenile Justice and Delinquency Prevention Act, and Trafficking Victim Prevention Act; and new guidance and regulations. This session will provide attendees with an overview and current status on these issues. Attendees will also learn how the experiences of their programs and youth can help inform decisions made by federal policymakers in Washington, DC, and in implementing those decisions in their communities.

Objectives:

1. To provide participants with a clear understanding of the federal policy issues impacting RHYA providers.
2. To provide participants with up-to-date information about the current status of these issues and the prospective outlook for policymakers to act on them.
3. To provide participants with information about how they can be actively engaged in educating the public and policymakers about the needs of youth and families served by RHYA programs.

Presenter:

Eric Masten, Director of Public Policy, National Network for Youth

Recommended Audiences:

All RHY/youth-serving professionals

Macro level— effort to help clients by intervening in large systems (e.g., contributing to state, regional, or national responses to youth; participating in broad evaluation studies; and educating decision makers on RHY needs)

Those who are experienced in the RHY field/workshop topic

Pershing North Social Media in RHY Programs

Summary:

RHY grantees may use social media platforms to generate and strengthen relationships with youth and communities, gain a better understanding of needs, build and enhance donor and volunteer partnerships, increase awareness, and leverage word-of-mouth marketing and advocacy.

Are agencies and programs making the most of social media? What are the opportunities and pitfalls of using social media to engage youth? Who should manage social media accounts, and what policies should be in place? Which platforms are worth the time and effort? This workshop will cover the ins and outs of social media from multiple angles.



Objectives:

1. To learn the definition of social media and gain a clear understanding of different platforms available and their uses.
2. To gain an understanding of the opportunities and challenges presented by an agency and/or program presence on social media.
3. To obtain information on the particular opportunities and pitfalls of using social media to engage young people.
4. To learn about steps for implementation of social media policy and procedures.

Presenters:

Erin Ryan, Senior Vice President, The Night Ministry
Gordon Vance, Director of Programs, National Runaway Safeline
Lucus Myrick, FYSB RHYTTAC National Advisory Board Member

Recommended Audiences:

All RHY/youth-serving professionals
Micro level—the most common practice; happens directly with an individual client or family
Those who are experienced in the RHY field/workshop topic

Pershing West Tools to Overcome Adversity and Build Resilience

Summary:

Trauma and toxic stress disrupt the development of the brain and other physiological systems. Youth with adverse childhood experiences (ACEs) are more at risk for stress-related diseases and cognitive impairment. Further trauma and toxic stress impact youth behavior and decision making, making it difficult to fulfill healthy life goals. By using research-based tools to identify what is happening in the brain and body, efforts can be made to calm the brain and body and to empower the person, which can lead to growth in emotional intelligence and improved empathy, health, and well-being.

Objectives:

1. To explore the impact of trauma and toxic stress on the brain and how at-risk youth are impacted.
2. To identify skills that help youth heal from trauma and toxic stress and learn how the brain can change through acquiring these skills.
3. To experience self-soothing exercises described in the Mind Matters curriculum and to learn about technology (apps) that can be used to assist youth.

Presenter:

Dixie Zittlow, Director of Outreach, The Dibble Institute

Recommended Audiences:

All RHY/youth-serving professionals
Mezzo level—practice dealing with small- to medium-sized groups, such as neighborhoods, schools, or other local organizations
Those who are experienced in the RHY field/workshop topic



Pershing East Building the Bridge from Box to Bed

Summary:

This workshop will discuss how creative and effective outreach practices and service liaisons can engage hard-to-reach runaway, homeless, and forgotten youth. It will explore some of the best practices in outreach work and discuss how to begin thinking creatively and how to set up such a practice. It will also tackle some upsides as well as difficulties in making this successful. In addition, the presenter will draw easy-to-follow connections between liaison/support services such as Safe Place® and local civic organizations and how these can best be used to bolster pre-existing Street Outreach Programs to expand availability and the variety of assistance provided.

Objectives:

1. To gain information and strategies on effective relationship building with runaway and homeless youth (RHY) and street youth (referred to as “Travelers” by Project Lighthouse).
2. To obtain information and perspectives on the goals of outreach and the role of the outreach worker.
3. To gain information and strategies on effective outreach methods with RHY and street youth.
4. To obtain information on policies and procedures for the safety of participants and youth.
5. To obtain resources on how to recognize and prevent human trafficking and how best to advocate for victims/survivors of human trafficking.

Presenter:

Andy Whipple, Program Manager, Sea Haven, Inc.’s Street Outreach Program, Project Lighthouse

Recommended Audiences:

Street Outreach Program

Micro level—the most common practice; happens directly with an individual client or family

New to the RHY field/workshop topic

Penn Valley Using the Nurtured Heart Approach® in Transitional Living Programs

Summary:

Often in runaway and homeless youth work, staff encounter some of the most intense young people, and making an impact that is powerful and meaningful can be challenging. The Nurtured Heart Approach® is a relationship-focused methodology that helps people build their inner wealth and use their intensity in successful ways. Join the presenters to explore what the Nurtured Heart Approach® is and how to use it with young people in TLP. Suggestions for program implementation will be provided as well as time to answer questions.

Objectives:

1. To gain a clear understanding of the Nurtured Heart Approach®.
2. To obtain instruction and training on how to practice the Nurtured Heart Approach® effectively with young people using The 3 Stands™.
3. To obtain ideas and strategies on how to implement the Nurtured Heart Approach® on a programmatic level.



Presenters:

Quinn Donnay, Transitional Living Program Manager, New Day Youth & Family Services
Brooke Tafoya, Director of Operations, New Day Youth & Family Services

Recommended Audiences:

Transitional Living Programs

Micro level—the most common practice; happens directly with an individual client or family

New to the RHY field/workshop topic

Roanoke

**Helping Your RHY Organization Succeed by Focusing on You:
It Really Is OK to Do!**

Summary:

A strong, highly engaged, and healthy executive leader is critical to the success of organizations that operate RHY programs. So, why do leaders often engage in behavior that is not healthy and which they would not consider acceptable in others? Why do executive leaders often not care for themselves—both physically and mentally? The presenter will discuss these questions with participants and use his own story to explore answers. Participants will be encouraged to reflect on their own self-care and what they can do to improve their leadership capacity through life balance.

Objectives:

1. To identify and discuss reasons why executive leaders often do not care for themselves as they should.
2. To learn different ways to prioritize needs as individuals, while still ensuring that organizations operate efficiently and effectively.
3. To identify behavior that can be changed in order to practice more self-care and be a more effective leader.

Presenter:

Paul Hamann, President and CEO, The Night Ministry

Recommended Audiences:

All RHY/youth-serving professionals

Macro level—effort to help clients by intervening in large systems (e.g., contributing to state, regional, or national responses to youth; participating in broad evaluation studies; and educating decision makers on RHY needs)

Experienced in the RHY field/workshop topic



Mission

Supporting Educational Access and Success for Youth Experiencing Homelessness

Summary:

In this session, attendees will learn about the educational rights and supports available to youth experiencing homelessness under federal laws such as the McKinney-Vento Homeless Assistance Act. Topics will include eligibility for McKinney-Vento services, K-12 educational rights, supports for the transition to higher education, and more. Attendees also will explore requirements for collaboration between school districts and RHYA providers, as contained in the December 2016 RHYA regulations, and strategies for their implementation. Attendees will have opportunities to ask questions for clarification and apply their learning through interactive scenarios.

Objectives:

1. To gain a greater understanding of the McKinney-Vento definition of homeless and educational supports available for McKinney-Vento-eligible youth.
2. To gain a greater understanding of the requirements for collaboration between school districts and RHYA providers, as contained in the December 2016 RHYA regulations, and strategies for their implementation.
3. To be able to ask questions for clarification and apply learning through interactive scenarios.

Presenter:

Christina Dukes, Federal Liaison, National Center for Homeless Education (NCHE)

Recommended Audiences:

All RHY/youth-serving professionals

Mezzo level—practice dealing with small- to medium-sized groups, such as neighborhoods, schools, or other local organizations

Experienced in the RHY field/workshop topic

Liberty

Developing and Pre-Testing a Human Trafficking Screening Tool for Runaway and Homeless Youth and Child Welfare-Involved Youth

Summary:

To collect more reliable data on the extent of human trafficking among runaway and homeless youth (RHY) and youth in the child welfare (CW) system, and to assess and address the needs of trafficking victims within this population, the U.S. Department of Health and Human Services funded a pilot project to identify effective pre-existing human trafficking screening protocols and develop a modified tool to be used in RHY and CW settings. The tool was tested with approximately 600 child welfare and runaway and homeless youth between the ages of 12 and 24 across three geographic areas. This presentation will focus on the development of this human trafficking screening tool and tool validation findings. The presenters will describe the strategy, process, and challenges regarding tool development and data collection, along with the correlations between trafficking and other risk factors, such as running away, drug use, and arrest history.

Objectives:

1. Participants will understand the importance of a validated human trafficking screening tool in RHY settings.
2. Participants will recognize the challenges and best practices of creating an effective screening tool.
3. Participants will recognize the challenges and opportunities of integrating an effective screening tool in RHY programs.

Presenters:

Meredith Dank, Research Professor, John Jay College of Criminal Justice
Lilly Yu, Research Associate, Urban Institute

Recommended Audiences:

All RHY/youth-serving professionals
Micro level—the most common practice; happens directly with an individual client or family
Experienced in the RHY field/workshop topic

12:15 p.m. – 1:45 p.m. Lunch Break (on your own)

1:45 p.m. – 3:15 p.m. General Federal Session
Century B/C

This annual session is an opportunity to hear from federal officials. The Family and Youth Services Bureau will provide updates on federal activities and efforts directly impacting the Runaway and Homeless Youth Program.

3:30 p.m. – 5:00 p.m. Workshop Session II

Regional Meetings with Federal Project Officers

Roanoke	Region I (CT, ME, MA, NH, RI, VT)
Pershing East	Region II (NJ, NY, PR, VI)
Pershing West	Region III (DE, DC, MD, PA, VA, WV)
Liberty	Region IV (AL, FL, GA, KY, MS, NC, SC, TN)
Century A	Region V (IL, IN, MI, MN, OH, WI)
Pershing South	Region VI (AR, LA, NM, OK, TX)
Mission	Region VII (IA, KS, MO, NE)
Penn Valley	Region VIII (CO, MT, ND, SD, UT, WY)
Pershing North	Region IX (AZ, CA, HI, NV, AS, GU, MP, TTPI)
Shawnee	Region X (AK, ID, OR, WA)

6:00 p.m. – 8:30 p.m. Grantees' Reception
Century B/C

An evening of networking is being provided for all training participants. Everyone's hard work on behalf of youth and families is worth celebrating! Don't miss out on this opportunity to meet new friends.



WEDNESDAY, NOVEMBER 15

7:30 a.m. – 5:30 p.m.
Century Foyer

Training Information Center Open
Exhibits Open

8:30 a.m. – 9:00 a.m.
Roanoke – Penn Valley Foyer

Poster Session Meet and Greet

The Poster Session is an opportunity to hear about some exciting practices of RHY agencies. Throughout the day, a select group of agencies will be showcasing their work, utilizing poster boards, handouts, and pictures.

Valley Youth House, Bethlehem, Pennsylvania

Summary:

This poster session will focus on presenting operational definitions of various runaway and homeless youth (RHY) outcomes. Examples will be provided. The poster will describe the process of measuring outcomes for at least two agencies and how those processes are used in program performance evaluation. This will be an interactive session where attendees can share their experiences in developing operational definitions.

Grant Type:

Transitional Living Program

Category:

Data Collection/Outcome Measurement/Program Evaluation

Program Contact:

Andrew Palomo; apalomo@valleyyouthhouse.org; 484.866.7183

Children's Center, Inc., Galveston, Texas

Summary:

This poster session will focus on specialized sub-population programming for Latino immigrant youth. The poster will highlight the use of cultural sensitivity in helping understand the youth experience in their country of origin and their journey away from home. Through the use of cultural sensitivity, staff is successful in gaining the youth's trust using a trauma-informed care approach to understand and address issues of long-time family separation and other family changes. The poster will also highlight the importance of collaborating with organizations regarding immigrant rights and legal services to provide for the future well-being of the youth.

Grant Type:

Basic Center Program

Category:

Data Collection/Outcome Measurement/Program Evaluation

Program Contact:

Armando Pequeno; apequeno@tcc1878.org; 409.789.0705

reStart, Kansas City, Missouri

Summary:

This poster session will provide awareness of the experiences lived by youth couch surfers and other homeless youth in general in the Kansas City area. The audience will gain insight on the various agency responses to youth homelessness and will be engaged in discussion to identify other effective resources that will further enhance the field's overall response.

Grant Type:

Transitional Living Program

Category:

Youth Driven, Youth Guided Programs and Initiatives

Program Contact:

Mia Scott; miascott1390@gmail.com; 816.472.5664

Hawaii Youth Services Network, Honolulu, Hawaii

Summary:

Hawaii's ethnic mix and island geography have created a unique culture, and materials developed for other cultures are often not effective there. When Hawaii's teens view these materials, they see young people in unfamiliar settings who do not look or speak like they do, and they do not feel the content is relevant to their lives. Hawaii Youth Services Network has involved youth in creating bullying prevention videos that are culturally relevant for Pacific Islander and Asian populations.

Grant Type:

Basic Center Program

Category:

Youth Driven, Youth Guided Programs and Initiatives

Program Contact:

Judith Clark; jclark@hysn.org; 808.499.9966

9:00 a.m. – 10:30 a.m. Workshop Session III

Century A Faith-Based Approaches to Serving Homeless Youth

Since 1900, Mel Trotter Ministries has helped restore faith and lives. On February 24, 1900, Mel Trotter and a group of community leaders opened a Mission at 95 Canal Street in Grand Rapids, MI. Since then, hundreds of thousands of men and women have restored their lives, thanks to the loving support they found at Mel Trotter Ministries.

Over the years, Mel Trotter Ministries has expanded and changed to keep up with the changing needs of the hungry, homeless and hurting people in Grand Rapids.

Objectives:

1. Participants will hear about Mel Trotter's work in the field of serving the homeless through their work in the development and implementation of permanent supportive housing solutions to sufficiently care for individuals who are often homeless due to severe mental illness or physical disability.
2. Participants will learn how Mel Trotter Ministries work in establishing relationships/partnerships with landlords and churches to purchase and/or build housing options that provide secure and stable housing for low-income individuals and families.
3. Participants will learn about Mel Trotter Ministries work to create a strategy to prevent homelessness, end the cycle of generational homelessness, and fulfill the organization's vision to end homelessness, one life at a time.
4. Participants will hear about Mel Trotter Ministries work to expand programming to include aftercare and wraparound services to ensure guests leaving the organization have access to support services while learning to maintain stable, permanent housing.



Presenter:

Dennis Van Kampen, CEO, Mel Trotter Ministries

Recommended Audiences:

All RHY/youth-serving professionals

Macro level— effort to help clients by intervening in large systems (e.g., contributing to state, regional, or national responses to youth; participating in broad evaluation studies; and educating decision makers on RHY needs)

Experienced in the RHY field/workshop topic

Pershing South Coordinated Entry: Operating a Community-Wide Integrated System

Summary:

Learn about Colorado Springs' journey toward a community-wide coordinated entry (CE) system that keeps youth in the priority list. This system operates with an integrated approach, producing a combined by-name list of youth, families, and individual adults that is prioritized weekly to connect people with available community housing resources.

Objectives:

1. To learn about the history of the organization's process and how a community-wide integrated system was selected.
2. To learn about a coordinated entry (CE) system that is fully integrated with all populations.
3. To gain insight on how youth can benefit from an all-population CE system.
4. To learn about key performance indicators and results after 12 months of operating an all-population integrated CE system.

Presenters:

Audrey Field, Deputy Director/Director of Programs, Urban Peak Colorado Springs

Allison Ometer, Outreach Case Manager, Urban Peak Colorado Springs

Recommended Audiences:

All RHY/youth-serving professionals

Mezzo level—practice dealing with small- to medium-sized groups, such as neighborhoods, schools, or other local organizations

Experienced in the RHY field/workshop topic

Pershing North Child Trafficking and Exploitation: A Prevention Perspective

Summary:

Through an interactive presentation informed by Love146 and United Against Human Trafficking's experience working with at-risk and exploited youth, the presenters will review basic concepts of human trafficking and exploitation from the lens of prevention. The presenters will also provide information on how to effectively reach and empower at-risk youth—a critical component for effectively addressing trafficking and exploitation. The focus will be on vulnerabilities among runaway and homeless youth and the connections between those vulnerabilities, grooming tactics and recruitment, and opportunities to respond to risky behaviors or existing abusive and/or exploitative situations in a trauma-informed way.

Objectives:

1. To define key terminology related to human trafficking (HT) and commercial sexual exploitation (CSE).
2. To appreciate the personal and environmental factors that can increase youths' vulnerability to HT/CSE.
3. To identify common indicators for HT/CSE and recruitment.
4. To learn to make appropriate referrals to providers that can meet the needs of vulnerable and exploited youth.
5. To describe a minimum of two effective prevention strategies.
6. To describe core principles of trauma-informed practice and its effect on participation in prevention education programming.

Presenters:

Kimberly Casey, Director of Prevention, Love146

Recommended Audiences:

All RHY/youth-serving professionals

Micro level—the most common practice; happens directly with an individual client or family

Experienced in the RHY field/workshop topic

Pershing West Do You Have What It Takes To Be a Peer Monitor?

Summary:

FYSB utilizes a Peer Reviewer Model in its efforts to accomplish the legislative requirements for evaluating RHY-funded grantees by pairing the Federal Project Officer (FPO), who has primary responsibility for all monitoring, with a Peer Monitor (PM), who has substantial experience as an RHY grantee.

The purpose of this workshop is to offer an opportunity for interested attendees to learn about the Peer Reviewer Model and determine whether they have what it takes to serve as a PM.

Objectives:

1. Participants will be provided with the philosophy and perspective that is the framework for monitoring RHY grantees.
2. Participants will learn the eligibility requirements to serve as a PM.
3. Participants will learn the necessary skills and abilities to be effective in serving as a PM.

Presenters:

FYSB Regional Program Managers: Areon Kelvington, Keith Wallace, and Jeff Daniels

FYSB Peer Monitor: Dr. Fonda Thompson, Executive Director, Open Arms, Inc.

Recommended Audiences:

All RHY/youth-serving professionals

Mezzo level—practice dealing with small- to medium-sized groups, such as neighborhoods, schools, or other local organizations

New to the RHY field/workshop topic



Pershing East Engaging Youth Voice in RHY Programming

Summary:

This workshop will provide RHY grantees with the tools to implement and engage a youth advisory group to improve programming and youth outcomes. Its purpose is to encourage RHY grantees to implement a youth advisory group as part of its positive youth development strategy.

Objectives:

1. To learn how including youth voice in a positive youth development strategy impacts the social and emotional well-being of young people and increases their engagement in programming.
2. To learn how to implement and utilize a youth advisory group, increase staff buy-in, and build agency support.
3. To obtain a toolkit to identify meaningful roles for young people in each organization.

Presenters:

Candace Musick, Youth Development Manager, The Night Ministry
Theodore Peso, Manager, Advocacy & Community Affairs, The Night Ministry

Recommended Audiences:

All RHY/youth-serving professionals
Micro level—the most common practice; happens directly with an individual client or family
New to the RHY field/workshop topic

Penn Valley Street Outreach as a Sustainable Program

Summary:

Participants will get an in-depth look at how Synergy Services and reStart have worked together throughout the past three years to provide street outreach services to runaway, homeless, and at-risk youth. Discussions will include how to collaborate with community agencies instead of competing with them, how to incorporate core philosophies (positive youth development, harm reduction, trauma-informed care) when working across agencies, how to utilize youth feedback to improve services, and how to address the needs of homeless youth and gaps in services on a macro level.

Objectives:

1. To learn how to collaborate with community agencies instead of competing with them.
2. To discover how to incorporate core philosophies when working across agencies.
3. To gather strategies on how to gain and use youth feedback to improve programs.
4. To address gaps in services for homeless youth in the community.

Presenters:

Cynthia Hoffman, Youth Street Outreach Program Manager, Synergy Services, Inc.
Rita Carr, Youth Program Manager, reStart

Recommended Audiences:

Street Outreach, all RHY/youth-serving professionals
Mezzo level—practice dealing with small- to medium-sized groups, such as neighborhoods, schools, or other local organizations
New to the RHY field/workshop topic

Roanoke

Rethinking Self-Care: For Weary Staff and Hard-to-Reach Youth

Summary:

Participants will be challenged to see self-care in a different light. Self-care is often dismissed—citing “not having enough time” or “being overwhelmed.” Research encourages a rethinking of attitudes about self-care and seeing its connection to one of the most powerful individual protective factors: self-regulation (Children’s Bureau, 2015). This session will incorporate Wichita State University’s Center for Combating Human Trafficking’s Lotus Model™ self-care tool that can be utilized with staff and youth. At the end of this session, participants will be able to identify the connection between self-care and self-regulation and have a tool to assist staff and youth with self-care strategies.

Objectives:

1. To examine supporting evidence for practicing self-care/self-regulation.
2. To identify and discuss three types of self-care: maintenance, emergency, and pampering.
3. To develop a personalized self-care plan.
4. To learn how to use the Lotus Model™ self-care tool with staff members, mentors, and consumers.

Presenters:

Risa Rehmert, Director of Program Development, Wichita State University, Center for Combating Human Trafficking

Allison Farres, Strategic Programming and Evaluation Specialist, Wichita State University, Center for Combating Human Trafficking

Recommended Audiences:

All RHY/youth-serving professionals

Micro level—the most common practice; happens directly with an individual client or family

Experienced in the RHY field/workshop topic



Shawnee

Public Policy with Aloha—A Powerful Tool for Improving RHY Services

Summary:

Public policy can be a powerful tool for improving services and resources for RHY—or a barrier to meeting their needs. Public policy can be influenced through building awareness and support, sharing data about needs and outcomes, and building relationships. Hawaii Youth Services Network will share its experiences in increasing community awareness of RHY, gaining the right for youth to consent for shelter admission and health care, and involving youth in public policy development.

Objectives:

1. To identify strategies that can be used for building community and key stakeholder awareness and support for RHY.
2. To learn about ways to involve youth in public policy development.
3. To describe methods for establishing consensus and avoiding conflict.
4. To obtain examples of successful public policy efforts affecting RHY.

Presenter:

Judith Clark, Executive Director, Hawaii Youth Services Network

Recommended Audiences:

All RHY/youth-serving professionals

Macro level—effort to help clients by intervening in large systems (e.g., contributing to state, regional, or national responses to youth; participating in broad evaluation studies; and educating decision makers on RHY needs)

Experienced in the RHY field/workshop topic

Mission

Runaway and Homeless Youth Data: Data Collection, Quality, and Usage

Summary:

FYSB staff and an RHY TA provider will review the latest RHY data collection requirements using HMIS, the challenges and best practices for maintaining a culture of data quality, and the new RHY Dashboard for utilizing data and monitoring the success and quality of individual RHY programs. Presenters will touch on general approaches as well as those unique for each RHY program and share best practices.

Objectives:

1. To gain a clear understanding of RHY data requirements.
2. To obtain concrete tips for ongoing maintenance of data quality.
3. To learn about efficient data collection over time depending on each individual RHY program type.
4. To understand how to implement best practices in data collection.
5. To be able to utilize RHY data using the new RHY-HMIS Dashboard for program analysis.

Presenters:

John McGah, RHY-HMIS Project Director, American Institutes for Research

Resa Matthew, Director, Division of Adolescent Development and Support, Administration on Children, Youth and Families, Family and Youth Services Bureau

Recommended Audiences:

All RHY/youth-serving professionals

Macro level—effort to help clients by intervening in large systems (e.g., contributing to state, regional, or national responses to youth; participating in broad evaluation studies; and educating decision makers on RHY needs)

Experienced in the RHY field/workshop topic

Liberty

The Open Table: A Model of Accessing the Resources of the Faith Community to Enrich the Lives of Young Adults Who Have Experienced Trauma or Who Are Aging Out of Foster Care

Summary:

Young adults who have experienced trauma and/or have come out of state custody or intensive services all too often end up struggling in poverty and are often homeless or without supports. Poverty is a huge unaddressed variable in young adult overall life, behavioral health, and economic outcomes. It would be an understatement to say that most human services professionals, especially mental health professionals, are not trained in intervening in poverty. This issue is rarely covered in university curriculum or dealt with in therapeutic interventions. Young adults with complex needs and their families experience poverty at higher rates than the general population.

The faith-based Open Table model of poverty reduction is spreading rapidly across the United States. After an explanation of the model and a presentation of a video highlighting a young adult who is a graduate of Open Table, the majority of the session will be a discussion about how to link with faith communities and the crucial role of government and faith collaboration in accessing natural supports from the community.

Objectives:

1. Participants will understand the history, principles, research outcomes, and current use of the Open Table model of poverty reduction for young adults.
2. Participants will learn about techniques of partnering with faith communities to access natural supports that can enrich the lives of young adults.
3. Participants will leave the workshop with a set of objectives to implement further connections with the faith community, including with Open Table.

Presenter:

John VanDenBerg, PhD, Consultant to Board of Directors and CEO, Open Table



10:45 a.m. – 12:15 p.m. Workshop Session IV

Century A Federal Criteria and Benchmarks for Achieving the Goal of Ending Youth Homelessness

Summary:

In 2017, USICH issued criteria and benchmarks for achieving the goals of ending family and youth homelessness. Over the coming months, USICH will be partnering with communities to pilot the criteria and benchmarks. This session will highlight the connection between federal criteria and benchmarks and revised performance measures to increase positive outcomes. Dialogue will include the role of youth providers and opportunities to strengthen core outcomes in the areas of housing stability, permanent connections, education and employment, and overall well-being, as part of a coordinated community response to prevent and end homelessness. Participants will participate in a dialogue with federal partners about current strategies and opportunities to strengthen coordination and collaboration across sectors to serve youth experiencing and at risk of homelessness.

Objectives:

1. To receive an overview of federal criteria and benchmarks for achieving the goal of ending youth homelessness.
2. Input on criteria and benchmarks—community implementation (pilots), supporting guidance.
3. To connect the criteria and benchmarks to core outcomes for youth and RHY performance measures.

Presenters:

Jasmine Hayes, Deputy Director, USICH
Staff from HHS, HUD, ED agencies

Recommended Audiences:

All RHY/youth-serving professionals

Macro level—effort to help clients by intervening in large systems (e.g., contributing to state, regional, or national responses to youth; participating in broad evaluation studies; and educating decision makers on RHY needs)

Experienced in the RHY field/workshop topic

Pershing South Serving Special Needs Populations in Maternity Group Homes

Summary:

The life-affirming effort of aiding women, children and families in and around pregnancy necessarily includes the promoting and providing housing resources and extended care. Strong housing services are the result of committed individuals and organizations striving for excellence in all areas. To inspire excellence among maternity home providers and articulate a collective voice, leaders from various housing organizations have formed a National Maternity Housing Coalition.

The National Maternity Housing Coalition values all housing efforts that seek to overcome the challenge of homelessness. The National Maternity Housing Coalition knows that there are many valuable organizations and heroic individuals who give tirelessly to providing housing. For a variety of reasons, the National Maternity Housing Coalition limits its efforts to life-affirming maternity homes with a faith based approach and/or service model.

Objectives:

1. Participants will learn about the key factors that differentiate maternity housing programs including minors/adult women (with or without other children) and staffing model (live-In house parents; live-In staff; rotating/shift staff; shepherding or host homes.)
2. Participants will hear about additional factors related to services including during pregnancy/post pregnancy/extended care; narrow/open admission criteria; licensed/nonlicensed and accreditation or review by outside organizations; and, infrastructure issues (i.e. size/capacity/budget/connections to other organizations.)

Presenters:

Mary Peterson, Heartbeat International, Housing Specialist, National Maternity Housing Coalition, Facilitator

Recommended Audiences:

Maternity Group Homes

Micro level—the most common practice; happens directly with an individual client or family

Experienced in the RHY field/workshop topic

Pershing North The Power of Prevention: Creating Safe Spaces for Runaway & Homeless Youth

Summary:

In the midst of National Runaway Prevention Month, this workshop will focus on the importance of intervention and prevention resources for runaway and homeless youth. National Runaway Safeline (NRS) and National Safe Place Network (NSPN) are coming together to talk about the importance of creating safety for youth in crisis. Runaway prevention is everyone's concern and requires a delicate balance of awareness, communication, collaboration, and community resources and support. Presenters will discuss ways participants can bring the topic of runaway prevention to the forefront by identifying programs like NSPN's 24/7 safety net for youth in crisis, Safe Place®, and NRS's 24/7 hotline and digital crisis services.

Objectives:

1. Participants will learn about the intervention resources provided by NRS through its hotline and digital services, as well as the network of Safe Place options available for youth in crisis.
2. Participants will be able to identify the importance of prevention resources in helping youth acquire life skills and build resilience. They will be able to identify the 14 module topics of the free, evidence-based Let's Talk curriculum and participate in several of the activities focused on creating safe spaces.
3. Participants will be able to demonstrate practical strategies for using the Let's Talk curriculum in their work, including specific implementation options. They will also learn how to get their communities involved in the topic of RHY prevention by identifying campaigns such as National Runaway Prevention Month and other activities.

Presenters:

Lindsey Kahney, Prevention Specialist, National Runaway Safeline

Susan Harmon, Director of Safe Place National Operations, National Safe Place Network

Recommended Audiences:

All RHY/youth-serving professionals

Micro level—the most common practice; happens directly with an individual client or family

New to the RHY field/workshop topic



Pershing West Education Rights of Youth Experiencing Homelessness

Summary:

A high school diploma and post-secondary education are important pathways out of homelessness for young people. This session will explain the rights of youth experiencing homelessness to access public K-12 and post-secondary education. Topics will include the McKinney-Vento Act (including rights to immediate enrollment without a guardian, school stability, transportation, participation in extra-curricular activities, assistance with credit recovery, and transitions to post-secondary education), financial aid for college, access to early childhood services for parenting youth, rights of immigrant youth, and students with disabilities. The session will provide specific tools to help providers advocate with schools for youths' rights.

Objectives:

1. To understand the rights of youth experiencing homelessness to enroll in school, remain stable in school, and receive support to graduate high school.
2. To understand how to help parenting youth access early childhood services for their children.
3. To gain basic information about the rights of immigrant youth and students with disabilities.
4. To understand how unaccompanied homeless youth can complete the FAFSA on their own to obtain financial aid for college.
5. To know exactly where to find additional information about education rights on the web, including contacts for individual states and localities.
6. To obtain specific tools (legal summaries, rights briefs, and specific advocacy strategies) to advocate for youths' rights with K-12 schools and institutions of higher education.

Presenters:

Patricia Julianelle, Director of Program Advancement and Legal Affairs, SchoolHouse Connection
Nicole Sequeira, McKinney-Vento Liaison, Independence School District

Recommended Audiences:

All RHY/youth-serving professionals

Mezzo level—practice dealing with small- to medium-sized groups, such as neighborhoods, schools, or other local organizations

New to the RHY field/workshop topic



Pershing East How to Identify the Legal Needs of Runaway and Homeless Youth and Where to Turn for Free Legal Assistance

Summary:

This session will discuss the wide spectrum of legal issues that homeless youth and young adults face when trying to move toward stability in their lives and what lawyers are trying to do to address those issues, both individually and systemically.

Runaway and homeless youth often experience legal issues that are barriers to housing, education, and employment: They often lack identification, they've been victims of identity theft, they're unaware of benefits and services that can help them, they have citations that have gone to warrant, they have juvenile and/or criminal records that need to be sealed or expunged, they may be young parents and have issues regarding child custody or child support, they may be victims of domestic violence and in need of protective orders, they may be undocumented immigrants—and the list literally goes on. While some issues can be resolved by self-advocacy, legal assistance is often the only way youth and young adults will be able to resolve other issues, and often that resolution is critical to a successful path forward. Youth and young adults are often unclear about when an issue is legal in nature, and this session will help non-lawyers assist youth in identifying those issues.

This session will also focus on the recent efforts of the American Bar Association (ABA) to help meet the legal needs of youth and young adults experiencing homelessness. The ABA has launched the Homeless Youth Legal Network to locate legal services across the country and improve the delivery of legal services to youth and young adults. The ABA is also trying to expand the reach of legal services across the country through a Presidential Initiative to match pro bono services of law firms with homeless youth/young adult shelters and service providers. This session will discuss the availability of services and highlight the model programs that are part of the Homeless Youth Legal Network.

Objectives:

1. Participants will better understand the broad range of legal issues of homeless youth and young adults (ages 13–26).
2. Participants will learn to spot common legal issues from a variety of examples.
3. Participants will learn about the types of legal services and how they can offer assistance to homeless youth and young adults.
4. Participants will hear from a model program that delivers legal services to homeless youth.
5. Participants will learn how to access legal services in their areas.

Presenters:

Linda Britton, Director, ABA Commission on Youth at Risk; Partner, Homeless Youth Legal Network
Eric Masten, Director of Public Policy, National Network for Youth; Director of HYLN Model Program (Youth Law Project at Mid-Minnesota Legal Aid, or Pegasus Legal Services for Children, New Mexico)

Recommended Audiences:

All RHY/youth-serving professionals

Micro level—the most common practice; happens directly with an individual client or family

Those who are experienced in the RHY field/workshop topic



Penn Valley

Mi Corazón: Redefining Advocacy When Working with Latin@ Youth Victims of Dating Violence

Summary:

This workshop will provide a victim-defined advocacy framework for safety planning with Latin@ youth in contact with current or former abusive partners. Through discussion, presentation, and case study, this workshop will explore risk analysis and decision making, including why they remain in relationships or in contact with ex-partners. The workshop will look at the services that are available, the basic needs of Latin@ youth, and how to provide responsive, trauma-informed, culturally relevant services.

Objectives:

1. To learn about the scope and unique characteristics of relationship violence among Latin@ runaway and homeless youth.
2. To examine culturally relevant factors associated with the experience of and responses to dating violence.
3. To learn about the resources and tools available to support Latin@ youth in developing the skills to form and sustain healthy and safe relationships.

Presenter:

Ivonne Ortiz, Training & Education Specialist, National Resource Center on Domestic Violence

Recommended Audiences:

All RHY/youth-serving professionals

Micro level—the most common practice; happens directly with an individual client or family

New to the RHY field/workshop topic

Roanoke

Transitional Living and Collegiate Success: Using Community Partnerships to Address Housing Needs and Educational Goals

Summary:

Synergy Services, Park University, and Truman Behavioral Health recently developed a partnership to (a) find creative solutions to transition youth out of shelters, (b) engage youth in secondary education, (c) create new social support networks for youth, and (d) create a model that other communities could adapt for similar housing concerns. Four youth lived on campus and were enrolled in coursework for one year. Park offered scholarships and Synergy provided social and health services. A brief synopsis of the current project, outcomes, lessons learned (includes strengths and opportunities for growth), a description of key partnerships, and replication will be explored.

Objectives:

1. To understand the role of collaboration in finding community solutions.
2. To identify barriers to housing success on college campuses.
3. To identify opportunities for replication at other institutions.

Presenters:

Dr. Tami Radohl, Director of Field Education, Assistant Professor, Synergy Services, Inc.

✱ Mitch Black, Assistant Program Manager, Synergy Services, Inc.

Recommended Audiences:

Transitional Living Programs

Mezzo level—practice dealing with small- to medium-sized groups, such as neighborhoods, schools, or other local organizations

Experienced in the RHY field/workshop topic

Shawnee Adapting Resources for Youth

Summary:

Acknowledging that dedicated resources and specialized programs for homeless youth are rare, this workshop covers strategies for adapting existing tools and services to the distinct needs of the RHY population. This presentation takes two angles of approach: (1) modifying resources for homeless adults to make them safe and navigable for youth and (2) adapting resources for youth to make them viable for youth experiencing homelessness. Strategies in casework and program management focus on equipping youth to navigate institutions and influencing institutions to better serve youth. Rather than assuming unlimited capacity or generous funding to install specialized programming, this presentation focuses on those resources available to grantees now, within their own communities. Specific resources covered include permanent supportive housing and rapid rehousing programs and coordinated intake protocol.

Objectives:

1. To obtain a field report from one of the first agencies to implement permanent supportive housing and rapid rehousing programs for youth, offering valuable insight for grantees that may consider adopting these models in the future.
2. To learn concrete strategies and best practices—from multiple levels within an agency—that are designed for implementation within the real world.
3. To learn how to document and share experiences on the leading edge of programs like PSH and RRH so that those experiences may inform the next generation of program design and differentiation for youth.

Presenter:

Elizabeth Larkin, Outreach Case Manager, Basic Center Coordinator, Youth Continuum

Recommended Audiences:

All RHY/youth-serving professionals

Mezzo level—practice dealing with small- to medium-sized groups, such as neighborhoods, schools, or other local organizations

New to the RHY field/workshop topic



Mission

Special Populations of Youth Experiencing Homelessness

Summary:

Service providers often have good intentions about offering care to vulnerable and underserved youth, but often lack the baseline cultural competency needed to fully address or understand the unique needs and backgrounds of underserved youth experiencing homelessness. This session will provide a basic understanding of orientation and gender identities and explore best practices for supporting underserved young people in RHY programs.

Objectives:

1. Participants will understand the difference between orientation and gender.
2. Participants will understand how prejudice and discrimination perpetuate homelessness in underserved young people.
3. Participants will learn best practices for supporting underserved young people in their programs.
4. Participants will gain tools and resources to take back to their organizations and communities.

Presenter:

Christa Price, Senior Program Officer, True Colors Fund
Justin Rush, Director of Public Policy, True Colors Fund

Recommended Audiences:

All RHY/youth-serving professionals

Mezzo level—practice deals with small-to-medium-sized groups, such as neighborhoods, schools, or other local organizations

New to the RHY field/workshop topic

Liberty

Harness the Power of Social Media to Boost Visibility and Impact

Summary:

Social media is a powerful tool. Not only do 92% of teens ages 13 to 17 report going online daily, but the majority of teens (71%) use more than one social media website. But social media isn't just for youth; a 2014 study of non-profit organizations found that 97% use Facebook to increase their visibility and engage with online audiences. This workshop will examine an interactive social media guide developed by the Adolescent Pregnancy Prevention (APP) Program to demonstrate how runaway and homeless youth (RHY) grantees can leverage the power of social media to enhance their programmatic efforts and tackle common challenges. RHY grantees will learn the key phases of social media strategy development and will be provided with a brief review of the website that hosts APP resources, The Exchange.

Objectives:

1. Planning the audience and objectives (e.g., enhance recruitment and retention of youth).
2. Selecting social media tools, choosing a digital ambassador, creating a schedule, and adopting a social media policy.
3. Brainstorming content to engage the audience, ranging from sharing content on Twitter to hosting a video contest on Facebook.
4. Enhancing social media efforts by monitoring metrics.

Presenter:

LeBretia White, APP Program Manager, Family and Youth Services Bureau

Recommended Audiences:

All RHY/youth-serving professionals

Micro level—the most common practice; happens directly with an individual client or family

Experienced in the RHY field/workshop topic

12:15 p.m. – 2:30 p.m. **General Session**

Century B/C

National Clearinghouse Mural Contest Winner Presentation

TLP – Teen Living Programs, Chicago, IL

Teen Living Programs is a non-profit organization that has supported and strengthened Chicago's most vulnerable young people for over 40 years. The program focuses solely on 14- to 24-year-olds who are experiencing homelessness and offers comprehensive, year-round services to address everything from emergency needs and housing to education, job readiness, and embracing a healthy lifestyle. Program services are available on Chicago's South Side, in neighborhoods of high poverty and violence, and where critical supportive services are lacking.

The young people served by TLP are survivors—of homelessness, trauma, and instability. They all have the extraordinary potential to rewrite their stories. Every day, the dedicated staff and volunteers of TLP work alongside the youth, encouraging them to focus their energy and potential on altering the course of their lives for the better.

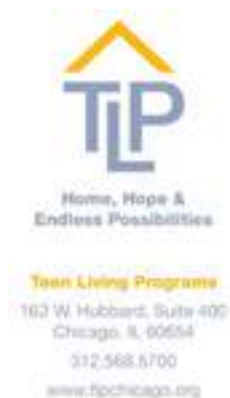

The youth who participated in this project were asked to create ideas on canvas that were incorporated into the “Dream Quilt.” Every other week for 10 sessions, Sinai volunteers assisted Margo Rush and Reba Blick, the artists who developed this program. The project allowed the youth to express their thoughts and feelings through art. Each session brought out more creativity and excitement among the group. Reba and Margo then put the individual canvases together, forming the “Dream Quilt.” The next venture, a “portable” mural, proved as successful as the quilt.



Keynote

William Wubbenhorst, Associate Commissioner, FYSB
Andrew Gluck, Carnegie Mellon University

William Wubbenhorst, Associate Commissioner for Family and Youth Services Bureau, will be presenting his vision for strengthening grantees' ability to collect, report, and utilize information pertaining to program outcomes. His presentation includes a new and different application of the logic model/theory of change process to assist community-based organizations in clearly specifying and measuring their outcomes. From there, Mr. Wubbenhorst will argue for a shift of grantee accountability from outputs to outcomes and will also include some exciting ideas and approaches for developing return-on-investment (ROI) measures as a means of communicating program value.

Following Mr. Wubbenhorst's presentation will be Andrew Gluck, who serves as a Performance Measurement and ROI Specialist for Pacific Institute for Research and Evaluation (PIRE). He will dive deeper into the work he has done to help community-based organizations to monetize their outcomes, communicate their impact in financial terms, and thus improve their ability to engage new stakeholders and sustain their programs. Following lunch, Mr. Gluck will also be hosting a workshop for those organizations that want to take a deeper dive into this exciting new world of outcomes-based management and services delivery.

2:45 p.m. – 5:30 p.m.

**Optional Site Visits:
Synergy Services, Inc., and reStart, Inc.**

Attendees with site visit tickets should meet at the front drive of the hotel by 2:45 p.m. Central time **with the site visit ticket** provided at check-in. Boarding will start at 2:45 p.m. and all participants must be in the boarding area by this time or risk losing their seat without a refund. Those interested in waiting in line for an opportunity to fill an empty seat may do so – please bring \$5 (exact change). RHYTTAC staff will fill empty seats at 2:55 p.m. until the allotted seat count is full.



2:45 p.m. – 5:30 p.m.

Extended Workshop: Rural Parts I and II (with break)

**Pershing South Rural Focus Institute: Piecing It All Together:
Diverse Funding for Rural Agencies**

Summary:

Diversified funding is crucial for rural programs to maintain effective services. This workshop will present participants with a variety of potential funding sources that can be accessed to support runaway and homeless youth. Panelists will present an overview of funding sources, explain funding processes and timelines, and discuss how agencies can deliver effective services while meeting all funding requirements.

Objectives:

1. To provide participants with information about potential funding.
2. To provide participants with specific steps on how to access funding.
3. To provide participants with examples of how diversified funding works on the ground.

Presenters:

Jeanne Duffy, Corporation for National and Community Service, AmeriCorps
Eric Masten, National Network for Youth (NN4Y)
Jean Block, Social Enterprise Ventures, LLC
Melanie Heitkamp, Mountain Plains Youth Services/Youthworks

Recommended Audiences:

All RHY/youth-serving professionals
Mezzo level—practice deals with small- to medium-sized groups, such as neighborhoods, schools, or other local organizations
Experienced in the RHY field/workshop topic



2:45 p.m. – 4:15 p.m. Workshop Session V

Pershing North Developing Survivor Leadership in RHY Programs

Summary:

Survivor leadership is a specialized construct of positive youth development focused on developing leadership among survivors of abuse, exploitation, and trafficking. For many RHY workers, it can be difficult to gauge the readiness of survivors and provide leadership opportunities. However, the benefits of survivor leadership are immeasurable. Allowing survivors to lead increases their resilience and protective factors and can improve service delivery in RHY programs. This session will explore the benefits of survivor leadership and methods of gauging survivor readiness and facilitating survivor leadership, and it will provide an example of a survivor leadership-focused program: Pathway to Prosperity.

Objectives:

1. To understand the concept of survivor leadership.
2. To learn specific methods for facilitating the development of survivor leadership.
3. To understand how survivor leadership can impact holistic healing and increase protective and resilience factors.
4. To review the Center for Combating Human Trafficking's "20 Ways to Develop Survivor Leadership."

Presenters:

Allison Farres, Strategic Programming and Evaluation Specialist, Wichita State University, Center for Combating Human Trafficking

Dr. Karen Countryman-Roswurm, Executive Director, Wichita State University, Center for Combating Human Trafficking

Recommended Audiences:

All RHY/youth-serving professionals

Micro level—the most common practice; happens directly with an individual client or family

New to the RHY field/workshop topic

Pershing West Providing Services to Special Populations of Homeless Youth

Summary:

This interactive workshop helps providers assess their programs for areas of growth and success in working with vulnerable youth and young adults. Participants will engage in learning best practices and terminology and identifying barriers within programs that interfere with providing services to vulnerable youth and young adults.

Objectives:

1. To provide participants with support in working with vulnerable youth and young adults in the community.
2. To provide participants with basic terminology.
3. To provide participants with skills in establishing a safe place for vulnerable youth.
4. To provide participants with support in addressing barriers involved with changing organizational practices to support vulnerable youth.

Presenters:

Erin Chapman Smith, Over-18 Transitional Living Program Manager, YouthCare
Emma York-Jones, Director of Under-18 Housing Services and Shelter Services, YouthCare

Recommended Audiences:

All RHY/youth-serving professionals
Micro level—the most common practice; happens directly with an individual client or family
New to the RHY field/workshop topic

Penn Valley Youth Voice! Learn How to Partner with Youth with Lived Experience to Inform Policy and Practice

Summary:

Learn how to partner with youth with lived experience to inform policy and practice and to support them in elevating their voice to effect change. The National Network for Youth (NN4Y) and SchoolHouse Connection (SHC) are dedicated to partnering with and acknowledging the expertise of young people who have run away, been expelled from home, or become disconnected from family. NN4Y established the National Youth Advisory Council (NYAC) to connect these individuals with the lawmakers, service providers, and community officials responsible for crafting policy solutions. SHC has a Youth Leadership and Scholarship Program to support the talents, motivations, and strengths of each young person and to develop community in each scholarship class. This workshop explores best practices to engage, empower, and partner with young leaders to reform existing systems so that young people are able obtain the help and resources needed for themselves and their peers. Young leaders will share their experience in partnering with NN4Y and SHC on reform policy and practice via pre-recorded video. They will share how they have played a role in leading successful partnerships.

Objectives:

1. To learn how to engage, empower, and partner with youth and young adult leaders to reform existing systems.
2. To learn the value of wholly engaging youth and young adult leaders in achieving organizational goals and objectives.
3. To receive resources to help organizations design and lead successful effective partnerships.

Presenters:

Yorri Berry-Harris, Director of Youth Engagement, National Network for Youth
Patricia Julianelle, Director of Program Advancement and Legal Affairs, SchoolHouse Connection

Recommended Audiences:

Street Outreach, All RHY/youth-serving professionals
Macro level— effort to help clients by intervening in large systems (e.g., contributing to state, regional, or national responses to youth; participating in broad evaluation studies; and educating decision makers on RHY needs)
Experienced in the RHY field/workshop topic



Roanoke

Monetizing Outcomes—Return on Taxpayers' Investment

Summary:

Congress has demanded accountability (in terms of outcome results as opposed to simply demonstrating that the program was running according to schedule) from managers of federal programs since the passage of the Government Performance and Results Act of 1993 (GPRA). In the current economic environment, it has become even more imperative for federal programs to demonstrate results to garner the financial support they deserve.

In this workshop, presenters will cover five key concepts: (1) focusing on outcomes, as opposed to the provision of service, to signal success; (2) highlighting different kinds of outcomes, including short-, intermediate-, and long-term outcomes; (3) monetizing those outcomes through ROI; (4) communicating ROI results to external stakeholders as a means for program sustainment; and (5) using the ROI results to inform internal management decision making.

Participants will continue their conceptual journey using logic models as a way of distinguishing outputs from outcomes and focusing on outcomes as a means of conveying a program's value. Presenters will reinforce and advance participants' paradigm shift in thinking by showing them how logic models and ROI calculations can be used to (1) prioritize which problems to attack, (2) rank actual and potential interventions, and (3) decide which data to collect to solidify credible and defensible estimates of future benefits.

Handouts will include logic model worksheets, ROI calculation worksheets, and a case study.

Presenter:

Andrew Gluck, MBA, Carnegie Mellon University

Recommended Audiences:

All RHY/youth-serving professionals

Macro level—effort to help clients by intervening in large systems (e.g., contributing to state, regional, or national responses to youth; participating in broad evaluation studies; and educating decision makers on RHY needs)

Advanced in the RHY field/workshop topic

Shawnee

Skill Building for Youth Who Are Pregnant or Parenting

Summary:

This workshop will inform participants of a specific tool and five-week program that can be duplicated to teach pregnant or parenting youth positive parenting techniques. Synergy Services has partnered with two local authors, Jerry Wyckoff and Barbara Unell, to deliver a parenting workshop based on their book *Discipline with Love and Limits*. This workshop comes with activities, video clips, handouts, and discussion prompts to deliver the information through multiple avenues.

Objectives:

1. To gain tools to define, prevent, and solve common parenting behavior challenges.
2. To obtain a guide to conduct a five-week parenting workshop at the local agency.
3. To obtain information on how parents can build positive relationships with their child.
4. To obtain information on why using the book *Discipline with Love and Limits* works.

Presenter:

Allison Willmann, Program Manager, Synergy Services, Inc.
Amy Coe, Parent Aide, Synergy Services, Inc.

Recommended Audiences:

Transitional living programs, maternity group homes, all RHY/youth-serving professionals
Micro level—the most common practice; happens directly with an individual client or family
Experienced in the RHY field/workshop topic

Mission

Evidence to Decision Making: Lessons from the Voices of Youth Count Initiative

Summary:

Data can be a powerful tool for programming. Drawing on the Voices of Youth Count (VoYC) national research initiative on youth homelessness, this workshop will highlight three areas in which programs and communities can build and use better data to inform strategies to end youth homelessness. These include (1) conducting comprehensive Youth Counts (“demand-side” assessment), (2) surveying local services (“supply-side” assessment), and (3) using intake and administrative data to inform ongoing programming decisions. The workshop will explore how such data can be community-led and can provide programming insights and evidence for local advocacy.

Objectives:

1. To learn how to support efforts in individual communities to produce better local estimates of youth homelessness and the characteristics of the population and how to use the data for programming and advocacy.
2. To gain insight into producing demand-and-supply assessments that inform more strategic programming and collaborations.
3. To gain insight into how well intake assessment scores predict youth service connections and outcomes and to discuss the implications for assessment and coordinated entry.
4. To learn about evidence and lessons from the Voices of Youth Count initiative and to share experiences of generating and using practical data to inform programming for better youth outcomes.

Presenter:

Beth Horwitz, Policy Analyst, Chapin Hall at the University of Chicago

Recommended Audiences:

All RHY/youth-serving professionals
Mezzo level—practice dealing with small- to medium-sized groups, such as neighborhoods, schools, or other local organizations
Experienced in the RHY field/workshop topic



Summary:

The vulnerabilities of RHY provide opportunities for human traffickers and exploiters to victimize this population. Agencies and service providers with direct access to these youths can utilize health indicators to identify at-risk youth as well as survivors and victims of commercial sexual exploitation. This presentation will utilize case studies, information from current research, and protocols used in other disciplines to teach grantees how to observe and speak with RHY to identify victims and prevent those at risk from becoming victims.

Goals of Presentation:

RHY grantees are on the front lines of the human trafficking battle and have special responsibilities to RHY who are at risk of being victims or are victims of trafficking to understand the problem of human trafficking, identify victims they serve as clients in their shelters and centers, and respond appropriately to help trafficking victims. Participants will learn how to identify the relevance of human trafficking to RHY providers; define human trafficking; explain how human trafficking affects RHY programs, shelters, and centers; identify human trafficking red flags and indicators in RHY and their situations; and explain the RHY grantee's role in combating human trafficking. Grantees will learn about resources available to victims and survivors of trafficking and how to partner with other groups, agencies, government services, and law enforcement to offer this assistance.

Objectives:

1. To receive a presentation on the problem of human trafficking and CSEC in the RHY population, indicators for identifying trafficking and responding appropriately and other practical applications for the information.
2. To learn how RHY services and intervention with targeted sub-populations of survivors of human trafficking and CSEC youth can be improved by recognizing health indicators for identification and intervention.
3. To discuss with grantees their experiences, ideas, and programs related to helping these targeted sub-populations.
4. To answer questions for further explanation of material covered and open up discussion to related topics or specific related topics not covered.

Presenter:

Laura J. Lederer, President, Global Centurion Foundation

**4:15 p.m. – 4:45 p.m. Poster Session Meet and Greet
Roanoke – Penn Valley Foyer**

The Poster Session is an opportunity to hear about some exciting practices of RHY agencies. Throughout the day, [a select group of agencies](#) will be showcasing their work, utilizing poster boards, handouts, and pictures.



THURSDAY, NOVEMBER 16

7:30 a.m. – 12:00 p.m.
Century Foyer

Training Information Center Open
Annual Banner Signing



8:30 a.m. – 11:00 a.m.
Century B/C

General Session

Voices of Youth Count

Dr. Matt Morton, Principal Investigator, Voices of Youth Count, Chapin Hall at the University of Chicago

Keynote

Merita Irby, Managing Partner, Big Picture Approach Consulting
Co-Founder and Executive Vice President, The Forum for Youth Investment

Closing Remarks

Family and Youth Services Bureau

RHYTTAC Reminders

Laurie Jackson, President and CEO, National Safe Place Network



MY SCHEDULE

Tuesday, November 14

7:00 a.m. – 5:30 p.m.

Visit Exhibit Booths

7:30 a.m. – 8:30 a.m.

Networking

8:30 a.m. – 10:30 a.m.

General Session: Opening Keynote (Location: Century B/C)

10:45 a.m. – 12:15 p.m.

Workshop Session I

My session: _____ Room: _____

12:15 p.m. – 1:45 p.m.

Lunch Break on my own or with: _____ Phone: _____
at: _____

1:45 p.m. – 3:15 p.m.

General Federal Session (Location: Century B/C)

3:30 p.m. – 5:00 p.m.

Workshop Session II

My region: _____ Room: _____ Officer: _____

6:00 p.m. – 8:30 p.m.

Grantees Reception (Location: Century B/C)

Wednesday, November 15

7:30 a.m. – 5:30 p.m.

Visit Exhibit Booths

8:30 a.m. – 9:00 a.m.

Poster Session Meet and Greet (Location: Roanoke – Penn Valley Foyer)

9:00 a.m. – 10:30 a.m.

Workshop Session III

My session: _____ Room: _____

10:45 a.m. – 12:15 p.m.

Workshop Session IV

My session: _____ Room: _____

12:15 p.m. – 2:30 p.m.

General Session: National Clearinghouse Mural Contest Winner Presentation
Keynote (Location: Century B/C)

2:45 p.m. – 4:15 p.m.

Site Visits to Synergy Services, Inc., and reStart, Inc.
Meet no later than 2:45 p.m. in front of hotel. *Bring site visit ticket.

2:45 p.m. – 4:15/5:30 p.m.

Workshop Session V or Rural Focused Presentation Parts I and II

My session: _____ Room: _____

4:15 p.m. – 4:45 p.m.

Poster Session Meet and Greet (Location: Roanoke – Penn Valley Foyer)

Thursday, November 16

7:30 a.m. – 8:30 a.m.

Annual Banner Signing (Location: Century B/C Foyer)

8:30 a.m. – 11:00 a.m.

General Session: Closing Keynote (Location: Century B/C)





Choose benefits
carefully designed to
meet your needs at
www.nspnetwork.org.

Base-level membership
starts at just \$200.

Personal

Professional coaching
Training of trainer opportunities
Tailored professional development
CYC training and certification
Emerging and executive leadership

Organizational

Fund development assistance
Board development assistance
Staff training support
Strategic visioning

Community

Post-emergency crisis support
Coalition-building
Advocacy training and support
Online networking forum

Connect

(w) www.nspnetwork.org
(e) info@nspnetwork.org
(fb) [nspnetwork](https://www.facebook.com/nspnetwork)
(tw) [nspntweets](https://twitter.com/nspntweets)



**Your needs.
Your network.
Together we can!**

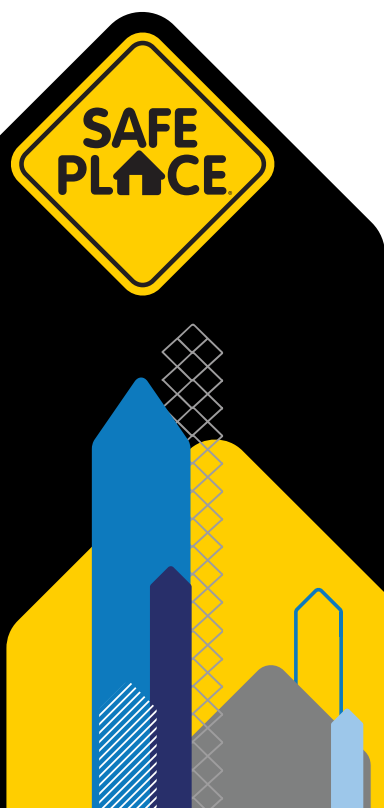

How do you help make your community safe for youth?

Visit the Safe Place® exhibit and share how you help
make your community safe for youth. Grab some
props and snap a photo to share on social media.



#SafePlace
nationalsafeplace.org

NETWORKING

Name: _____

Organization: _____

Phone Number: _____

Email Address: _____

Note: _____

Name: _____

Organization: _____

Phone Number: _____

Email Address: _____

Note: _____

Name: _____

Organization: _____

Phone Number: _____

Email Address: _____

Note: _____

Name: _____

Organization: _____

Phone Number: _____

Email Address: _____

Note: _____

Name: _____

Organization: _____

Phone Number: _____

Email Address: _____

Note: _____

Name: _____

Organization: _____

Phone Number: _____

Email Address: _____

Note: _____

Name: _____

Organization: _____

Phone Number: _____

Email Address: _____

Note: _____

Name: _____

Organization: _____

Phone Number: _____

Email Address: _____

Note: _____

Name: _____

Organization: _____

Phone Number: _____

Email Address: _____

Note: _____

Name: _____

Organization: _____

Phone Number: _____

Email Address: _____

Note: _____

Name: _____

Organization: _____

Phone Number: _____

Email Address: _____

Note: _____

Name: _____

Organization: _____

Phone Number: _____

Email Address: _____

Note: _____





Get logged into innovation.

We found a new home for your old logbooks.

Toss away those paper logbooks with that other stuff you no longer need, because we've made them completely obsolete.

We take hand-written information from traditional logbooks and digitize it so you can easily search, share, and capture your information in real-time on mobile and smart devices... anywhere.



Learn more at NoteActive.com.

NOTE ACTIVE

RHY PROGRAM NETWORK



National Safe Place Network

Proud Operator of FYSB RHYTTAC

Runaway and Homeless Youth Program Network

2017 National RHY Grantees Training Host

"National Safe Place Network (NSPN) ensures an effective system of response for youth in crisis through public and private partnerships at a local, state, and national level. They do this through the operation of three nationally recognized programs: NSPN Membership, Safe Place®, and FYSB RHYTTAC. To learn how NSPN can work with you and your staff to end youth homelessness and ensure safety for all youth in crisis, visit www.nspnetwork.org, email info@nspnetwork.org, or call 502.635.3660. Your needs. Your network. Together we can!"

NSPN IS PROUD TO OPERATE



FYSB Family & Youth
Services Bureau
Runaway and Homeless
Youth Training & Technical
Assistance Center

CONNECT WITH YOUR FYSB RHYTTAC TEAM AT:

Phone: 888.290.7233

Email: info@rhyttac.net

Address: 2722 Crittenden Drive, Louisville, KY 40209

National Clearinghouse for Homeless Youth and Families

Runaway and Homeless Youth Program Network

Exhibitor

"The Administration for Children and Families and the Family and Youth Services Bureau (FYSB) is pleased to announce the launch of its new clearinghouse, the National Clearinghouse on Homeless Youth and Families (NCHYF), dedicated to spotlighting and sharing information and resources to support grantees and organizations that serve runaway and homeless youth (RHY). Many of you may be familiar with the former National Clearinghouse on Families and Youth, or NCFY, which provided information and resources on topics for serving family and youth.

Recognizing the need for resources focused on runaway and homeless youth, in 2017 FYSB shifted focus and established NCHYF, which is FYSB's first RHY-only clearinghouse. With the technical expertise of Manhattan Strategy Group to operate NCHYF, FYSB will focus the efforts of NCHYF on serving organizations and communities that work every day to put an end to youth experiencing homelessness. NCHYF will work to identify and meet the needs of RHY service providers, including providing information on and access to research, literature, best practices, evidence-based approaches, trends, and success stories. Additionally, NCHYF will have resources for our RHY grantees that promote collaboration with other local and federal partners."



National Runaway Safeline

Runaway and Homeless Youth Program Network

Exhibitor

"National Runaway Safeline (NRS) serves as the federally designated national communication system for runaway, homeless, at-risk youth and their families. Each year, NRS makes more than 250,000 connections to help and hope

through its crisis hotline (1-800-RUNAWAY) and online services such as chat, text, email, and forum (www.1800runaway.org). NRS provides solution-focused crisis intervention and prevention services to youth families and community members throughout the country. NRS also manages the Home Free program in collaboration with Greyhound Lines, Inc."

EXHIBITORS AND ADVERTISERS



American Institutes for Research

*NSPN - RHYTTAC Cooperative Agreement Partner
Exhibitor*

“American Institutes for Research (AIR) is an independent, non-partisan, not-for-profit organization whose mission is to conduct and apply the best behavioral and social science research and evaluation toward improving people’s lives, with a special emphasis on the disadvantaged and most vulnerable populations. AIR is committed to understanding and addressing the unique needs of children, youth, and adults experiencing homelessness by researching what works, developing tools and resources, and providing training and technical assistance to support data-driven, trauma-informed programming.”



Youth Catalytics

*NSPN - RHYTTAC Cooperative Agreement Partner
Exhibitor*

“Youth Catalytics is a non-profit training and research organization dedicated to improving the health and well-being of young people in communities across the country. It works hand-in-hand with programs on the ground, helping them build their infrastructure, employ best practices, and respond quickly to emerging issues that impact the lives of the young people they serve. For 35 years Youth Catalytics has connected with hundreds of programs that reach out and assist disconnected and homeless youth, pregnant and parenting teens, LGBTQ youth, and children and youth marginalized by poverty.”



National Network for Youth

Exhibitor

“The National Network for Youth (NN4Y) has been a public education and policy advocacy organization dedicated to the prevention and eradication of youth homelessness in America for over 40 years. As the largest and most diverse network of its kind, NN4Y mobilizes over 300 members and affiliates—organizations that work on the front lines every day to provide prevention services and respond to runaways and youth experiencing homelessness and human trafficking.”



The Dibble Institute

Exhibitor

“One’s love life is NOT neutral! The Dibble Institute offers evidence-informed and evidence-based curricula to help teens learn how to make wise choices about life, relationships, dating, partners, sex, and more. These programs follow positive youth development standards and take an innovative approach by integrating factors of relationship skills with powerful learning strategies that expand social and emotional well-being.”





Safe Place®

Exhibitor

“Safe Place is a national outreach and prevention program for youth in need of immediate help and safety. This initiative involves community support to provide safe havens and resources for youth in crisis. Nearly 20,000 community and business locations nationwide display the Safe Place sign,

making help readily available. Safe Place locations include libraries, schools, YMCAs, fire stations, fast food restaurants, grocery stores, transit companies, and social service facilities. To learn more about Safe Place or to bring Safe Place to your community, visit www.nationalsafeplace.org.”



Child Welfare Information Gateway

Exhibitor

“Child Welfare Information Gateway provides access to timely, practical resources that help child welfare, adoption,

and related professionals protect children and strengthen families.

For more information visit www.childwelfare.gov.”



National Institute of Mental Health

Exhibitor

“The National Institute of Mental Health (NIMH) is part of the National Institutes of Health, an agency of the U.S. Department

of Health and Human Services. NIMH conducts and supports research on the brain and disorders of mental health. For more information, contact NIMH Science Writing, Press, and Dissemination Branch, 6001 Executive Boulevard, Room 6200, MSC 9663 Bethesda, MD 20892-9663; Toll-Free: 866.615.6464; TTY Toll-Free: 866.415.8051; Email: nimhinfo@nih.gov; Website: www.nimh.nih.gov”



True Colors Fund

Exhibitor

“Co-founded by Cyndi Lauper, the True Colors Fund works nationally to end homelessness among lesbian, gay, bisexual, and transgender youth. Through a broad continuum of training

and education, youth collaboration, and advocacy programs, the True Colors Fund is creating a world where all young people can be their true selves. For more information visit www.truecolorsfund.org.”



MANY

Exhibitor

“MANY is the only national network of its kind that engages stakeholders across sectors to strengthen outcomes for youth and young adults at highest risk for victimization and/or delinquency. MANY is committed to cultivating evidence, unearthing and sharing innovation, improving outcomes, and increasing cross-sector collaboration.”



Wichita State University
Center for Combating Human Trafficking
Exhibitor

“The Center for Combating Human Trafficking (CCHT) is committed to empowering the nation’s capacity to provide effective prevention, assessment/identification, intervention, and aftercare/prosperity services. As one of its six methods toward meeting this mission, CCHT offers training and technical assistance utilizing one of the only evidence-informed approaches for serving victims and survivors of abuse, exploitation, and trafficking, the Lotus Anti-Trafficking Model™. Lotus™ is both a philosophy and a set of practices that assist multidisciplinary professionals in effectively serving young people in crisis.”



NoteActive
Major Advertiser

“NoteActive is a green technology (Green Tech) software product that replaces antiquated handwritten paper-based logbook documentation practices with modern digital logbook software. It aims to harness the power of technology and promote workplace advances that increase the productivity of its clients. NoteActive strives to build environmentally friendly software that helps modernize and advance workplace innovation for users across multiple industries through digital information capture, information dissemination, cloud accessibility, and analytics that better the performance of its users, their organizations, the communities they serve, and the world. Learn more at www.noteactive.com.”



Academy for Competent Youth Work
Advertiser

“The Academy for Competent Youth Work offers leading-edge professional development and consultation for professionals and organizations that serve children, youth, and families. Its CYC: Basic Course engaged 1,800-plus youth workers across the United States. The Academy for Competent Youth Work’s collaboration with the Center for the Study of Social Policy created the Youth Thrive and Families Thrive curricula to help practitioners, programs, and communities thrive. In 2015 it launched the blended online and live Motivational Interviewing and CYC: Foundations Courses. The organization comprises youth workers collaborating with youth for a better future.”



National Partnership for Juvenile Services
Advertiser

“The National Partnership for Juvenile Services (NPJS) is a strong alliance of educators and trainers, including detention, corrections, residential treatment, and community-based professionals, united in voice, service, and advocacy for justice-involved youth. NPJS provides professional development and technical assistance and promotes best practices to the field of juvenile justice and delinquency prevention to positively impact youth, families, and communities. The organization is built on trust, commitment, honesty, integrity, and excellence, with the idea that change is possible. Learn more at www.npjs.org.”



SOCIAL MEDIA

2017 National RHY Grantees Training attendees are encouraged to interactively participate in events by using social media. The official hashtag, #RHYTraining17, may be used to share resources, quotes, photos, and more. Social media use during the training provides great networking opportunities and opens digital doors for those not attending to learn from the content shared.

Share your experience!
#RHYTraining17

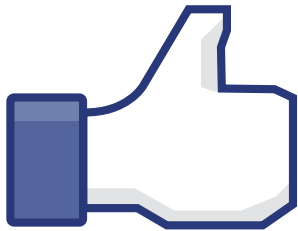

facebook.com/rhyttac

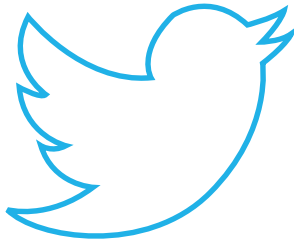

twitter.com/rhyttac

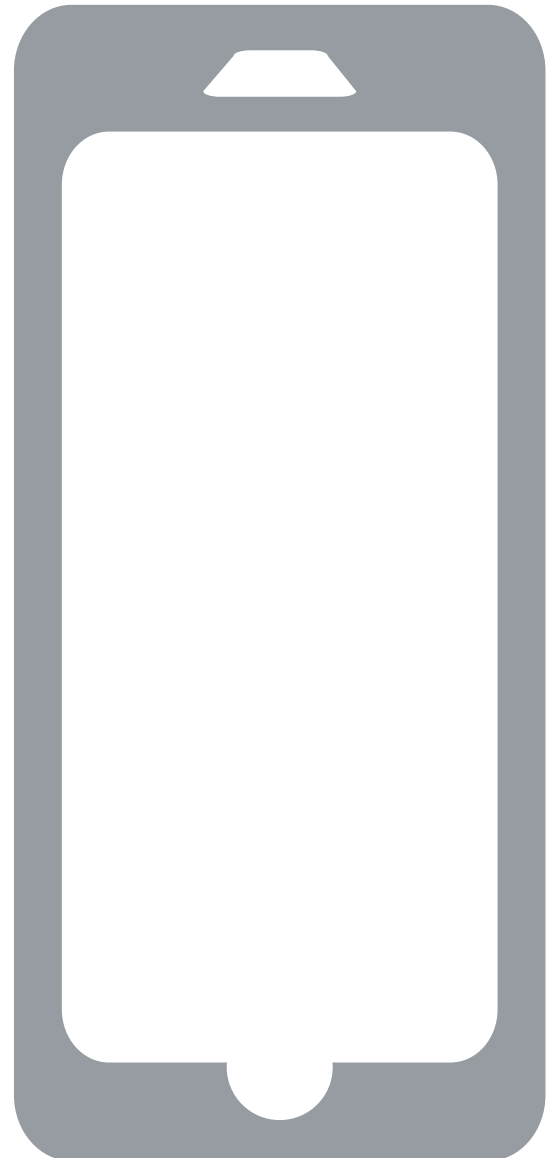

The National Partnership for Juvenile Services provides professional development and technical assistance and promotes best practices and standards to the field of juvenile justice and delinquency prevention to positively impact youth, families and communities.

www.npjs.org



WE TRANSFORM YOUTH WORKERS

ACTIVE, ENGAGING AND FUN CYC FOUNDATIONS COURSE

Relational	Strengths-based
Asset Focused	Trauma Informed
Brain-based	Diversity Inclusive
Evidence Informed	CYC Certification Credit

ONLINE AND ONSITE. TRAINING FOR TRAINERS.

YouthWorkAcademy.org

SUPPORT

RHYTTAC Advisory Board

Patricia Balke	Clayton Gonzales	Lucus Myrick
Avery Belyeu	Sissie Hadjiharalambous	Carol O'Brien
Mary Ann Cunningham	Melanie Heitkamp	Andrew Palomo
Lisa Davis	Catherine Hummel	Pauletta Red Willow
Katie Doyle	Elisabeth Jackson	Risa Rehmert
Rachel Francis	Karen Locke	Erin Ryan
Eric Gilmore	Kirstin London	Gordon Vance
Lisa Goldsmith	Kim McNear	Dina Wilderson

2017 National RHY Grantees Training Planning Committee

Federal Staff

Danny Balkcom
Janice Holt
Alicia Parks
Kimberly Waller
Angie Webley

Advisory Board Members

Patricia Balke
Rachel Francis
Eric Gilmore
Kirstin London
Kim McNear
Andrew Palomo
Erin Ryan

RHY Grantees

Rebecca Buckles
Rita Carr
Kami Diaz
Lorraine Flores
Kaysie Getty
Grace Loesher
Josh Louwerse
Bethany Pombar
Raymond Primes
Jan Williams
Erika Willis
Robert Wood



NSPN – RHYTTAC STAFF

National Safe Place Network – RHYTTAC Staff

Laurie Jackson, President/CEO

ljackson@nspnetwork.org

Tammy Hopper, Chief Strategic Initiatives Officer

tammy@nspnetwork.org

Elizabeth Smith Miller, Director of Marketing and Events

esmiller@nspnetwork.org

Mark Wolf, Director of Training and Technical Assistance

mwolf@nspnetwork.org

TC Cassidy, Director of Organizational Advancement

tccassidy@nspnetwork.org

Shauna Brooks, Performance and Evaluation Specialist

sbrooks@nspnetwork.org

April Carthorn, General Specialist

acarthorn@nspnetwork.org

Sherry Casey, Operations and Administration Manager

scasey@nspnetwork.org

Zach Elmore, Operations Specialist

zelmore@nspnetwork.org

Kim Frierson, Training Specialist

kfrierson@nspnetwork.org

Susan Harmon, Director of Safe Place National Operations

sharmon@nspnetwork.org

Rachel Hurst, Development Associate

rhurst@nspnetwork.org

Hillary Ladig, Communications Coordinator

hladig@nspnetwork.org

Autumn Sandlin, Operations Specialist

asandlin@nspnetwork.org

Eric Tadatada, Technical Assistance Specialist

etadatada@nspnetwork.org



NOTES

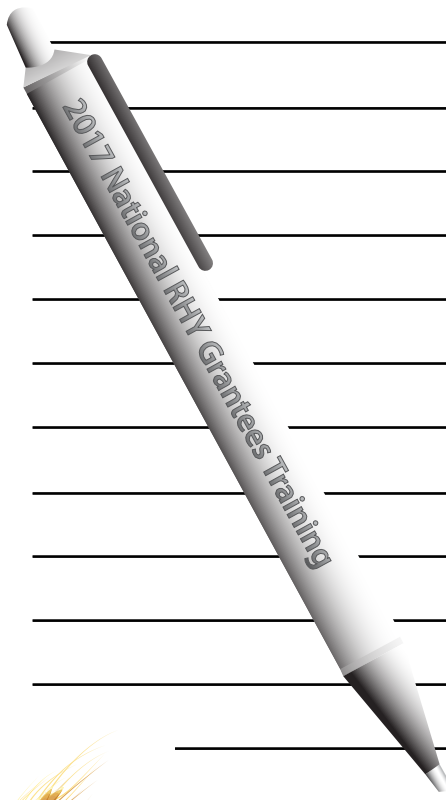

Handwriting practice lines consisting of 20 horizontal lines. A wavy line is drawn across the bottom of the lines, starting from the left and ending near the pen.

2017 National RHY Grantees Training





Lined writing area with horizontal lines. A pen is positioned diagonally across the lines, with the text "2017 National RHY Grantees Training" written on its barrel. The pen tip is touching the bottom line, and a wavy line is drawn below it.



Handwriting practice lines consisting of 20 horizontal lines. A wavy line is drawn across the bottom of the lines, starting from the left margin and ending near the bottom right corner.

2017 National RHY Grantees Training





Handwriting practice lines consisting of 20 horizontal black lines on a white background.

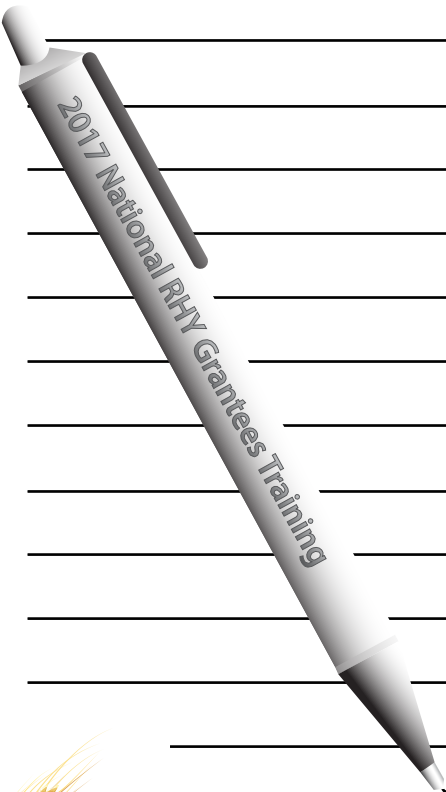

Handwriting practice lines consisting of 20 horizontal lines. A wavy line is drawn across the bottom of the lines, starting from the left and ending near the pen.

2017 National RHY Grantees Training



CONTACT



(w) www.acf.hhs.gov/programs/fysb



Runaway and Homeless Youth Training & Technical Assistance Center

(p) 888.290.7233
(w) www.rhyttac.net
(e) info@rhyttac.net
(fb) [/rhyttac](https://www.facebook.com/rhyttac)
(tw) [@rhyttac](https://twitter.com/rhyttac)



2722 Crittenden Drive
Louisville, KY 40209
(w) www.nspnetwork.org



Runaway and Homeless Youth Training & Technical Assistance Center

Operated by:

